

TOV

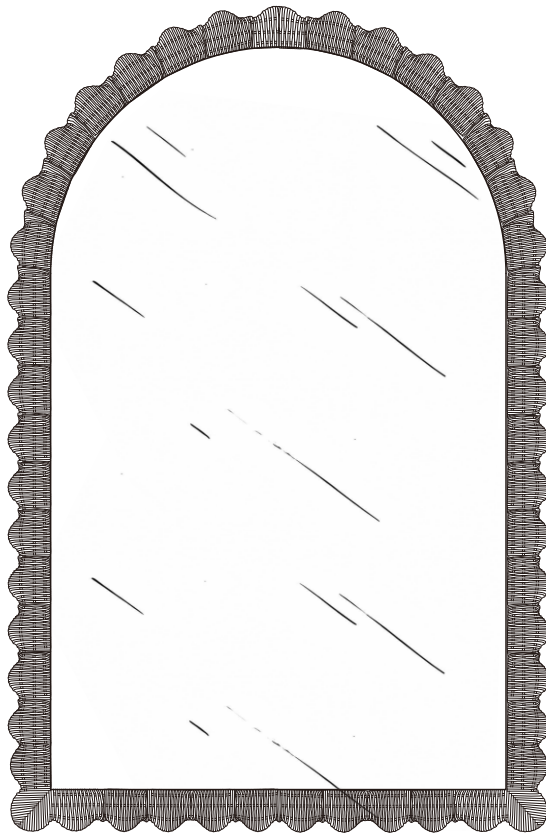

**BAMA JUMBO RATTAN
ARCHED WALL MIRROR**

DON'T BE BORING.

Hardware and Components



..... (A) Mirror x 1 Pcs
...

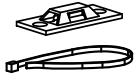

..... (B) Tipping Restraint x 1 Set
...

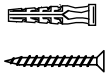

..... (C) Wall Bolt & Screw x 1 Set
...

Step1

Open box of hardware and legs.

This hardware box will be a smaller box inside of the main box. Look for the red streamer.



Step 2

Hang the mirror on the wall, make sure it is mounted.

Tools required



Hanging screws are not included

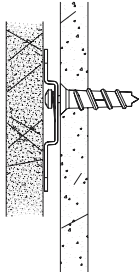

- If there is only gyproc, use screw and hanging screw to hang the mirror on the wall.

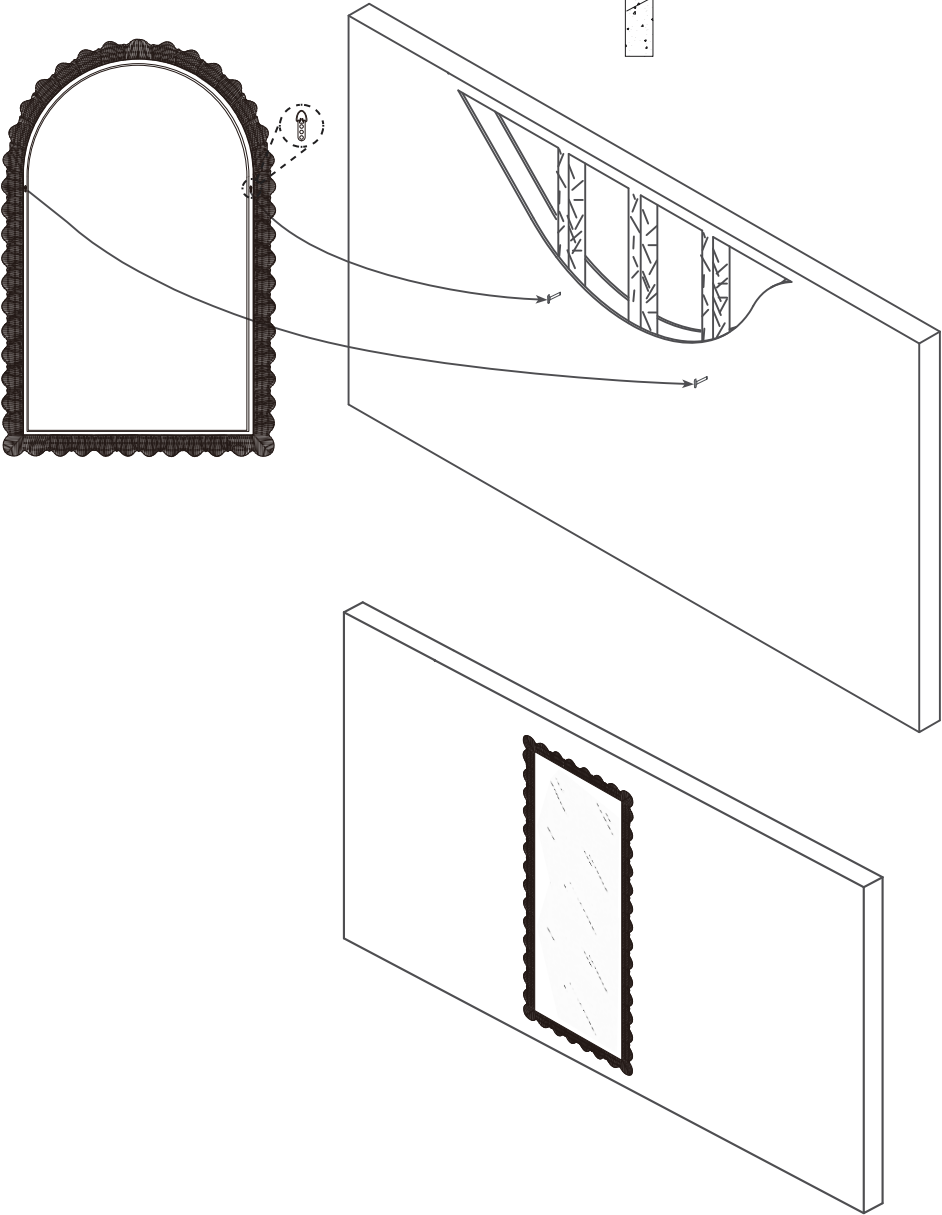

Step 3

Ensure the mirror is leveled, then fully tighten the hardware.

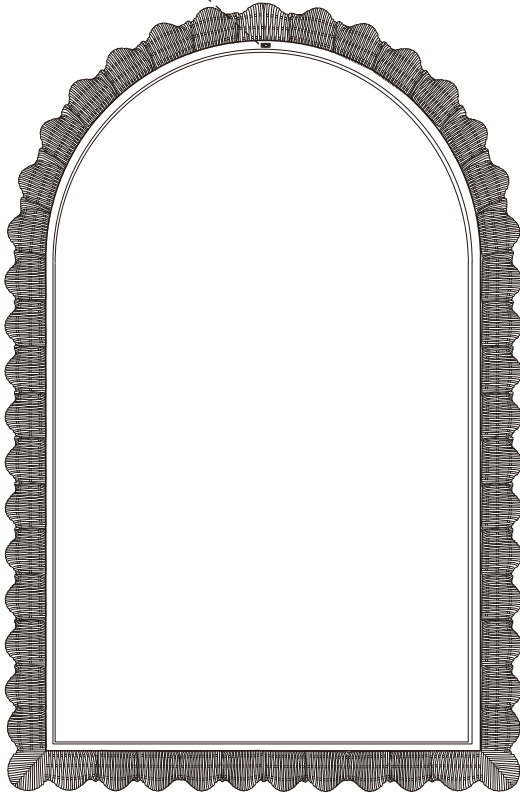
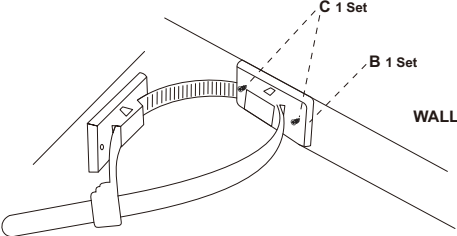
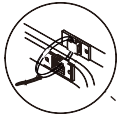

Step 4

A. Complete!

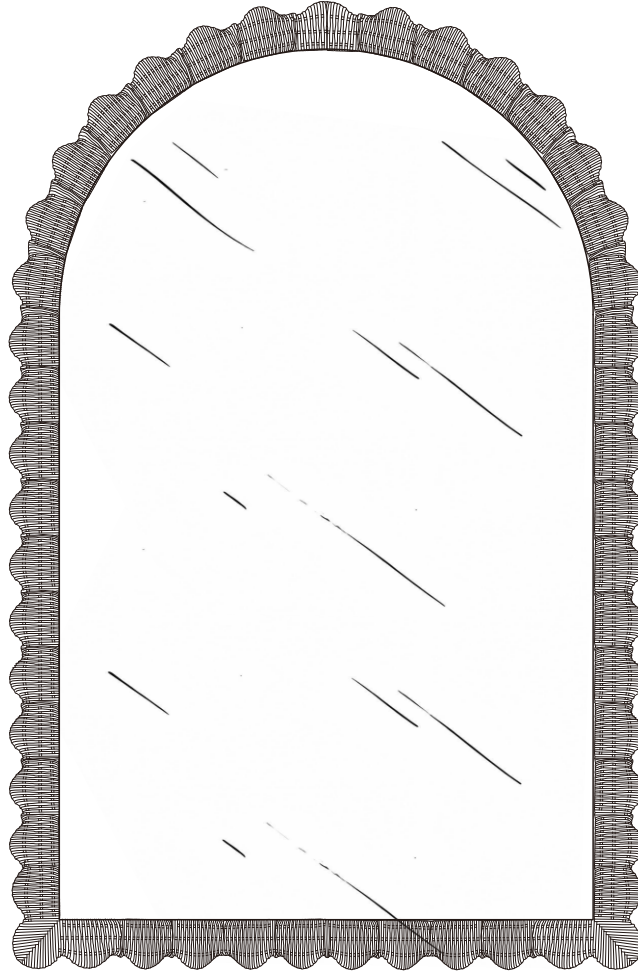

Stuck?

Contact our team @ 516-888-3355
Scan for product care!



TOV



Follow us!

Show your new purchase some love by tagging it on our Instagram !



@tovfurniture



516-888-3355



hello@tovfurniture.com



www.tovfurniture.com

If the future is female—your furniture should be, too. No mahogany in sight. Sexy settees shaped like lips. Price points for any budget. At TOV, we do things differently.