

ASSEMBLY INSTRUCTIONS

Desk

EEl-7436 / V0.07.10.25

modway



Questions? Contact us!
609.256.9000
cs@modway.com

Welcome. Let's get started.

Before you begin, here are some things to keep in mind:

Assembly will take most people **about 60 minutes**. Consider having a friend help you!

Only use hand tools to assemble this item. Do not use power tools. Do not tighten bolts or screws completely until all hardware is lined up and inserted into the holes.

Read through all of the instructions before starting. Make sure you have all parts and components before discarding any packing materials.

Do not over-tighten screws and bolts to avoid stripping the hardware or cracking the item.

Assemble your item on a flat, carpeted area, with plenty of space to work. This will prevent damage and scratches to your floors or the item while you're assembling the product.

Keep all components and packaging out of reach of children or animals to avoid risk of choking or suffocation.

Care instructions are listed in the last step of this manual.

WAIT!

Missing parts or hardware? Need assistance?
Contact us before returning your item.
We're here to help!



HARDWARE INCLUDED IN THE BOX:

A		Screw M3 x 16 mm (RB)	x2
B		Screw M3.5 x 15 mm	x8
C		Screw M6 x 9 mm	x44
D		Screw M6 x 40 mm	x35
E		Wood Dowel Ø6 x 20 mm	x12
F		Wood Dowel Ø8 x 25 mm	x44
G		Bolt Dowel 20 x 5 mm	x55
H		Cam Lock 15/12	x31
J		Cam Lock 15/10	x24
K1		Drawer Slide CR (300mm)	x1
K2		Drawer Slide CI (300mm)	x1
L1		Drawer Slide DR (300mm)	x1
L2		Drawer Slide DL (300mm)	x1
M1		Push Open Drawer Slide CR (300mm)	x4
M2		Push Open Drawer Slide CL (300mm)	x4
N1		Push Open Drawer Slide CR (350mm)	x2
N2		Push Open Drawer Slide CL (350mm)	x2
P		Wire Rod (Ø5 x 250)	x4
Q		Plastic Leg Stud	x8
R		Allen Key	x1
S		Backply Stopper	x8
		Tipping Restraint Kit	x1

WHAT YOU NEED:



Phillips

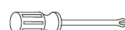

Phillips Head Screwdriver

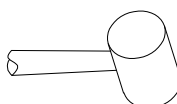

Mallet

FURNITURE COMPONENTS INCLUDED IN THE BOX:

All parts are numbered with a sticker according to this list.

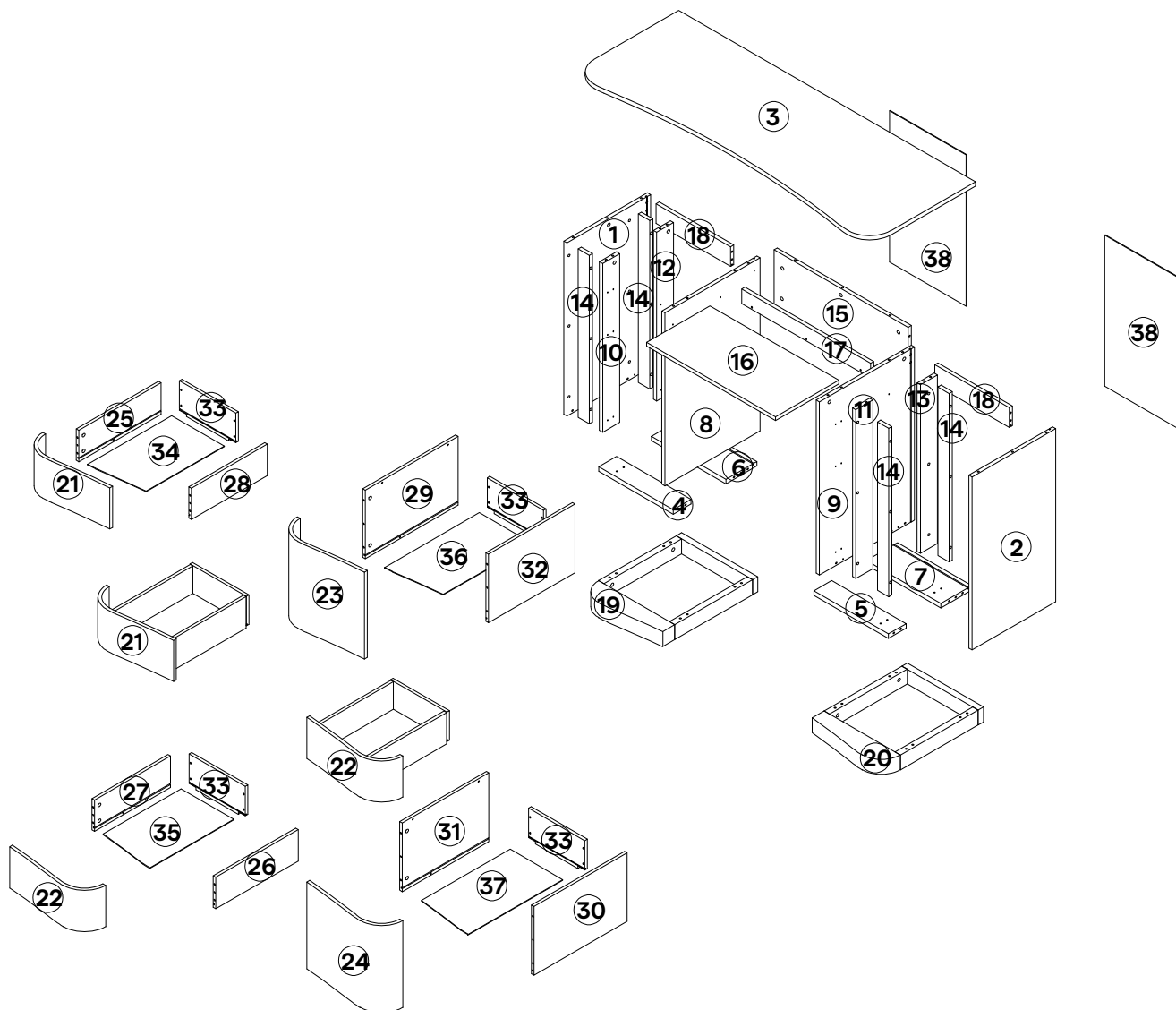

FURNITURE COMPONENTS INCLUDED IN THE BOX:

All parts are numbered with a sticker according to this list.

1	Left Side Panel	x1	14	Front Panel	x4	27	Right Drawer Left Drawer Side	x2
2	Right Side Panel	x1	15	Center Back Support Panel	x5	28	Left Drawer Right Drawer Side	x2
3	Top Panel	x1	16	Keyboard Tray	x1	29	Bottom Left Drawer Left Drawer Side	x1
4	Left Front Rail Panel Bottom	x1	17	Back Keyboard Tray	x1	30	Bottom Right Drawer Right Drawer Side	x1
5	Right Front Rail Panel Bottom	x1	18	Back Support Panel	x2	31	Bottom Right Drawer Left Drawer Side	x1
6	Left Back Rail Panel Bottom	x1	19	Left Bottom Frame	x1	32	Bottom Left Drawer Right Drawer Side	x1
7	Right Back Rail Panel Bottom	x1	20	Right Bottom Frame	x1	33	Drawer Back	x6
8	Left Partition Panel	x1	21	Left Drawer Front	x2	34	Left Drawer Drawer Bottom	x2
9	Right Partition Panel	x1	22	Right Drawer Front	x2	35	Right Drawer Drawer Bottom	x2
10	Left Side Rail Panel	x1	23	Bottom Left Drawer Front	x1	36	Bottom Left Drawer Drawer Bottom	x1
11	Right Side Rail Panel	x1	24	Bottom Right Drawer Front	x1	37	Bottom Right Drawer Drawer Bottom	x1
12	Left Side Support Panel	x1	25	Left Drawer Left Drawer Side	x2	38	Back Panel	x2
13	Right Side Support Panel	x1	26	Right Drawer Right Drawer Side	x2			

HARDWARE

- F** Wood Dowel Ø8 x 25 mm x18
- G** Bolt Dowel 20 x 5 mm x16

COMPONENTS

- 1** Left Side Panel x1
- 2** Right Side Panel x1
- 4** Left Front Rail Panel Bottom x1
- 5** Right Front Rail Panel Bottom x1
- 6** Left Back Rail Panel Bottom x1
- 7** Right Back Rail Panel Bottom x1
- 9** Right Partition Panel x1

1.1 Insert **Wood Dowel (F)** into innermost pre-drilled holes on the top edge of **Left Side Panel (1)**, **Right Side Panel (2)** and **Right Partition Panel (9)**, left and right edge of **Left and Right Front Rail Panel Bottom (4 and 5)**, **Left and Right Back Rail Panel Bottom (6 and 7)**.

1.2 Insert **Bolt Dowel (G)** into innermost pre-drilled holes on the right side of **Left Side Panel (1)** and **Right Partition Panel (9)**, left side of **Right Side Panel (2)** and **Right Partition Panel (9)**, left and right edge of **Left and Right Front Rail Panel Bottom (4 and 5)**, **Left and Right Back Rail Panel Bottom (6 and 7)**.

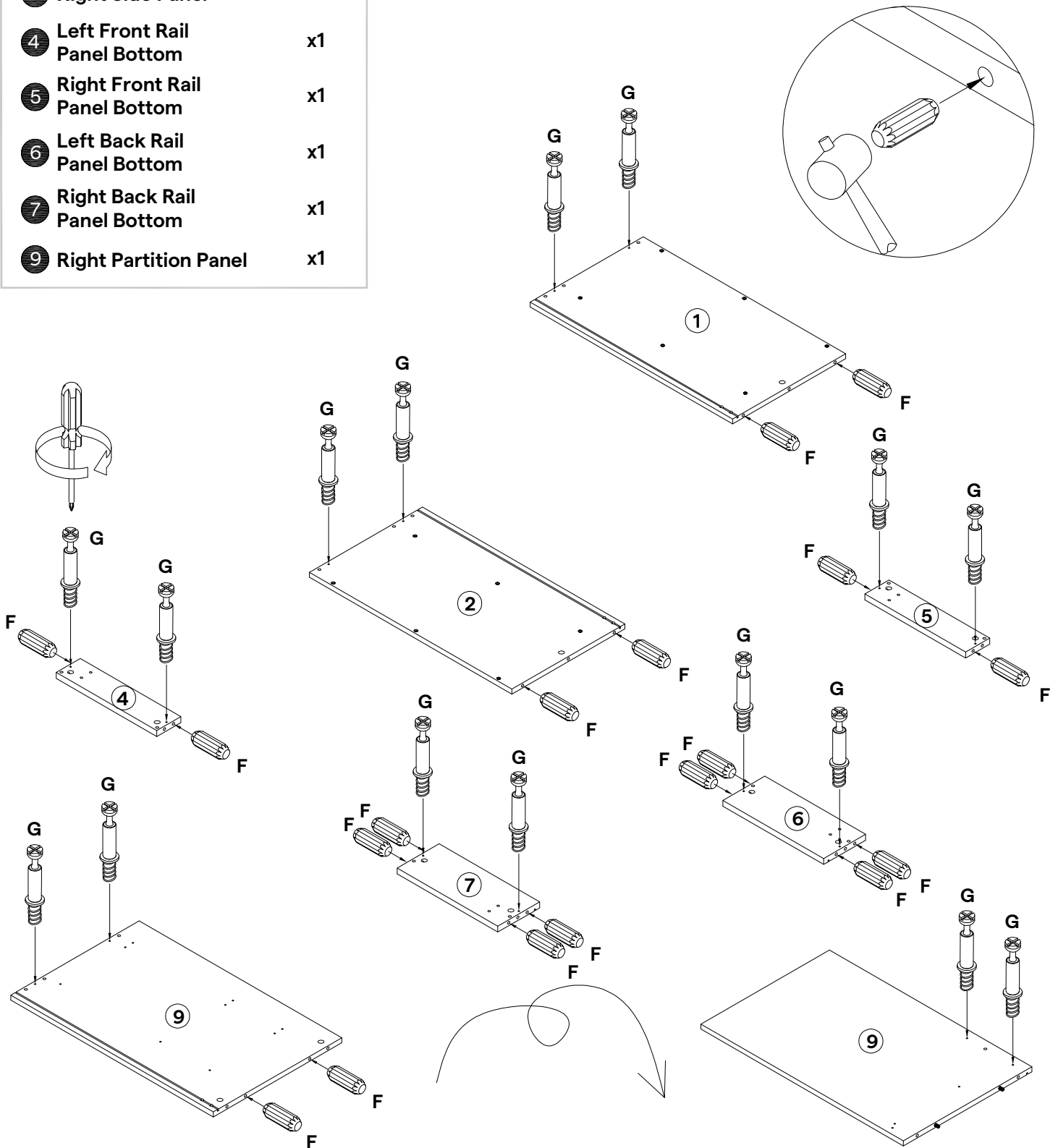

HARDWARE

- F** Wood Dowel Ø8 x 25 mm x18
- G** Bolt Dowel 20 x 5 mm x4

COMPONENTS

- 8** Left Partition Panel x1
- 10** Left Side Rail Panel x1
- 11** Right Side Rail Panel x1
- 12** Left Side Support Panel x1
- 13** Right Side Support Panel x1
- 15** Center Back Support Panel x1
- 18** Back Support Panel x2

2.1 Insert **Wood Dowel (F)** into innermost pre-drilled holes on the top edge of **Left Partition Panel (8)**, **Left and Right Side Rail Panel (10 and 11)**, **Left and Right Side Support Panel (12 and 13)**, **Center Back Support Panel (15)**, left and right edge of **Center Back Support Panel (15)**, **Back Support Panel (18)**.

2.2 Insert **Bolt Dowel (G)** into innermost pre-drilled holes on the left and right side of **Left Partition Panel (8)**.

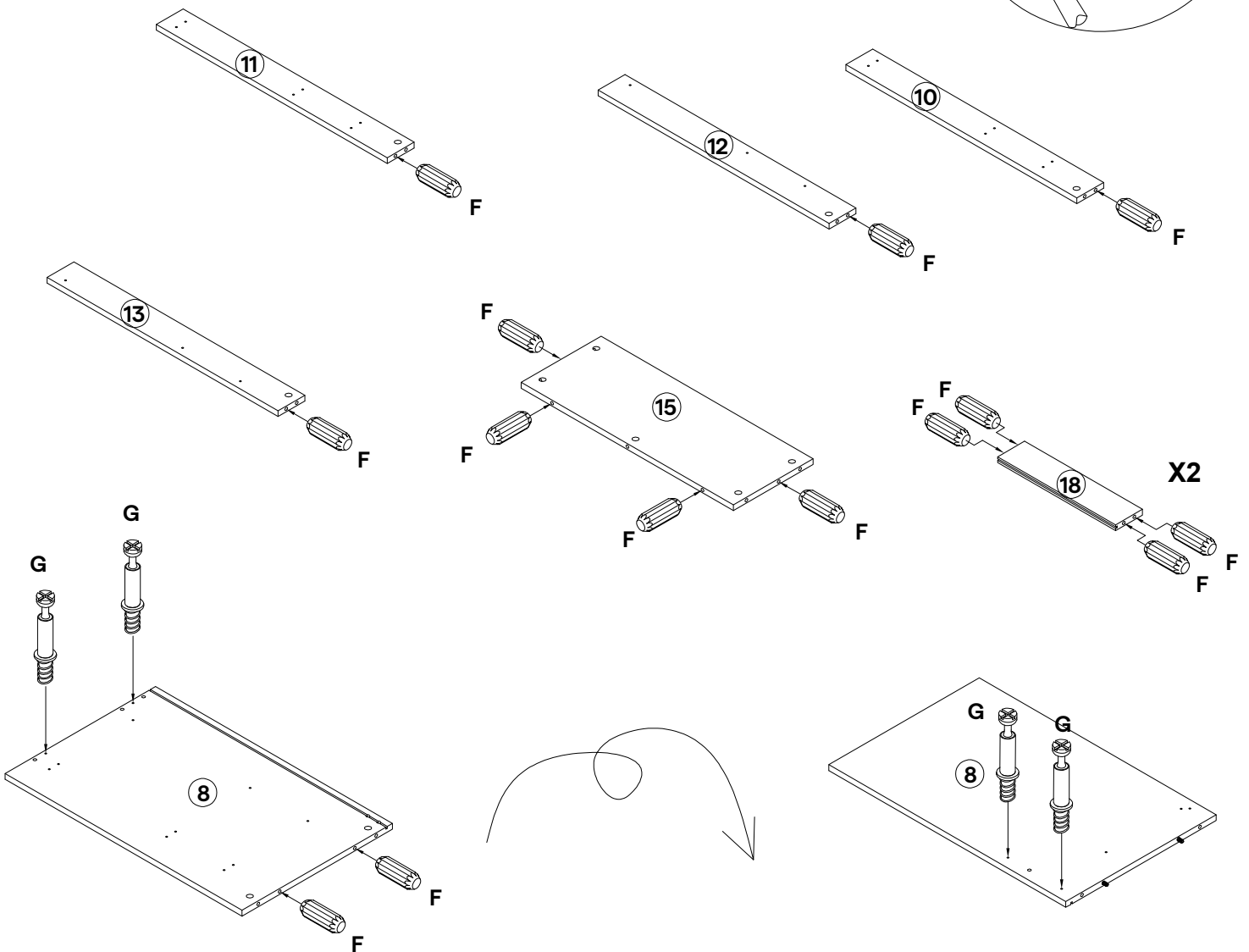
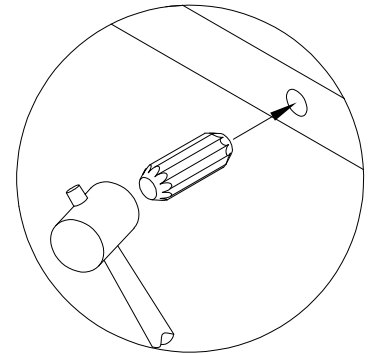

COMPONENTS

- ① Left Side Panel x1
- ② Right Side Panel x1
- ⑭ Front Panel x4

3.1 Connect **Front Panel (14)** to **Left Side Panel (1)** and **Right Side Panel (2)** by inserting Plastic Head Panel Clip to the corresponding holes.

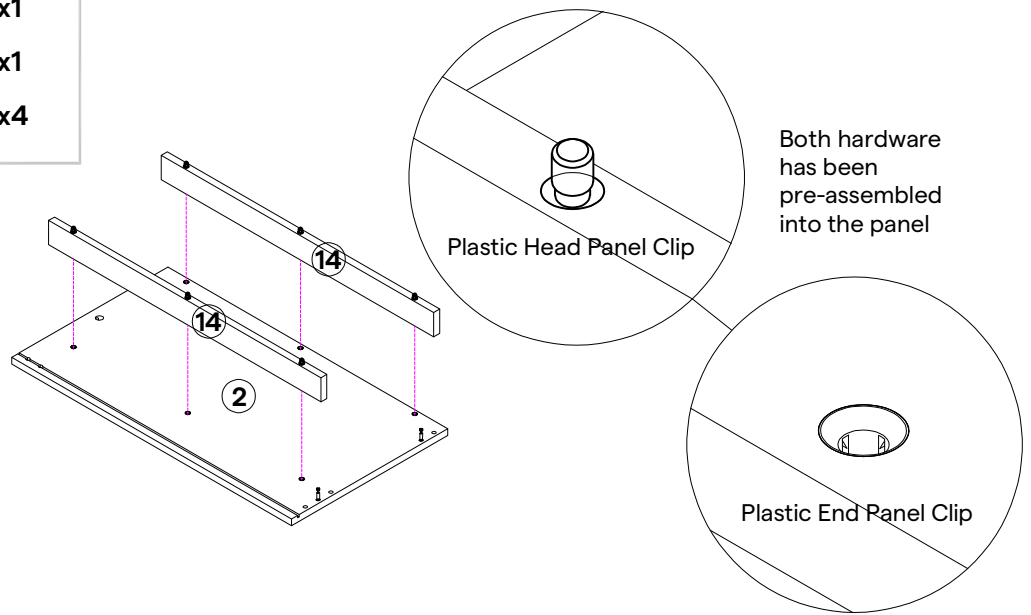
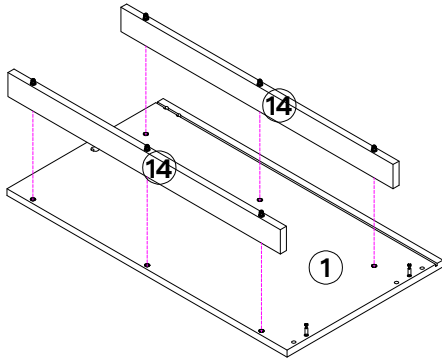

STEP 04

HARDWARE

- Ⓒ Screw M6 x 9 mm x18
- Ⓜ1 Push Open Drawer Slide CR (300mm) x2
- Ⓜ2 Push Open Drawer Slide CL (300mm) x2
- Ⓝ1 Push Open Drawer Slide CR (350mm) x1
- Ⓝ2 Push Open Drawer Slide CL (350mm) x1

COMPONENTS

- ⑩ Left Side Rail Panel x1
- ⑪ Right Side Rail Panel x1
- ⑫ Left Side Support Panel x1
- ⑬ Right Side Support Panel x1

4.1 Attach **Push Open Drawer Slide CR (M1)** and **Push Open Drawer Slide CR (N1)** to **Right Side Rail Panel (11)** and **Right Side Support Panel (13)** using **Screw (C)**.

4.2 Attach **Push Open Drawer Slide CL (M2)** and **Push Open Drawer Slide CL (N2)** to **Left Side Rail Panel (10)** and **Left Side Support Panel (12)** using **Screw (C)**.

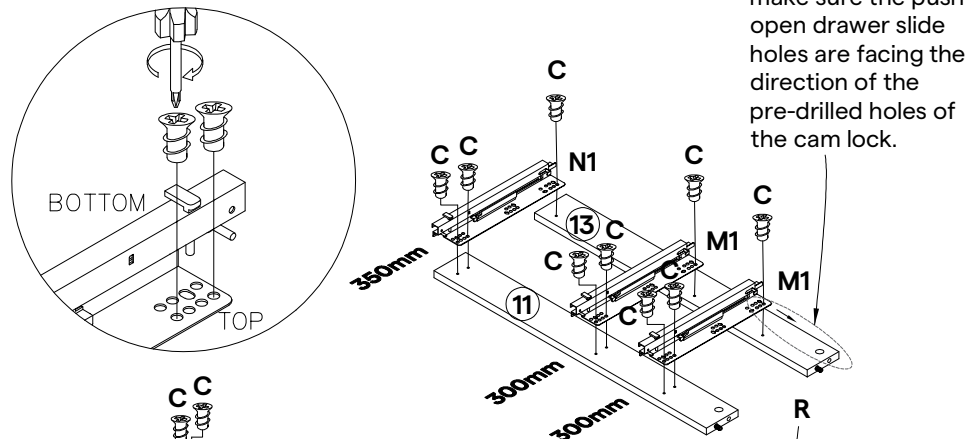

make sure the push open drawer slide size are correct by looking at the number on the push open drawer slide.

The push open drawer slide with the button lock side should be secured on the panel side with 2 holes.

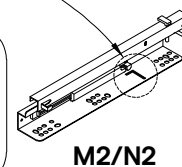
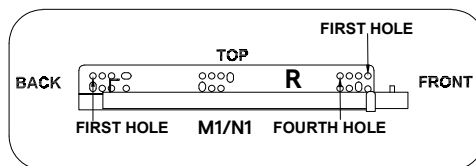
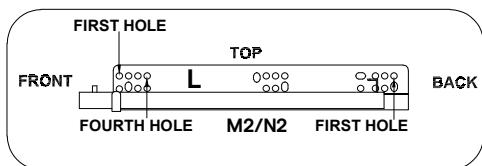

COMPONENTS

1	Left Side Panel	x1
2	Right Side Panel	x1
10	Left Side Rail Panel	x1
11	Right Side Rail Panel	x1
12	Left Side Support Panel	x1
13	Right Side Support Panel	x1
14	Front Panel	x4

5.1 Connect **Left Side Rail Panel (10)** and **Left Side Support Panel (12)** to **Front Panel (14)** by inserting Plastic End Panel Clip to the corresponding holes.

5.2 Connect **Right Side Rail Panel (11)** and **Right Side Support Panel (13)** to **Front Panel (14)** by inserting Plastic End Panel Clip to the corresponding holes.

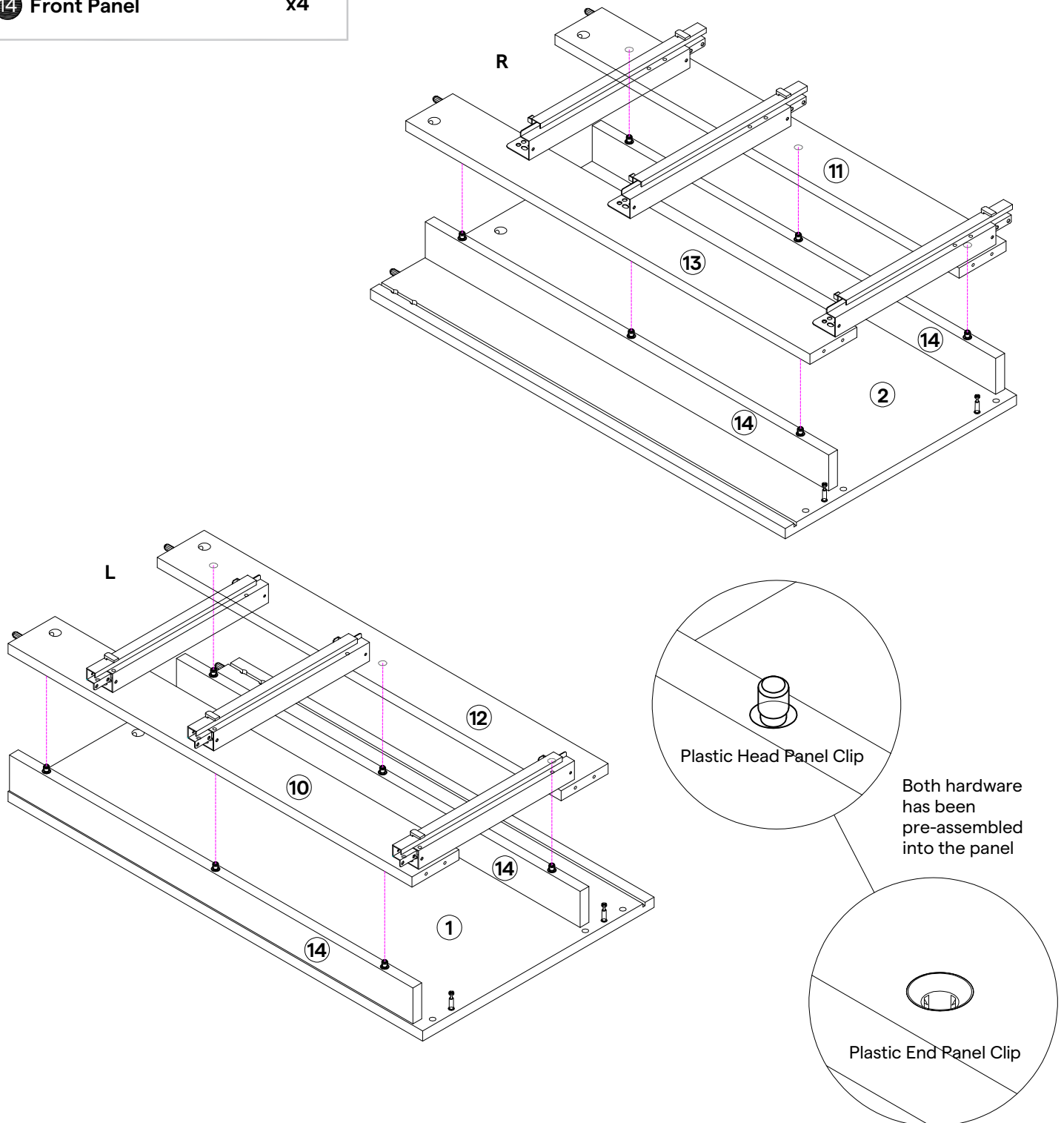

HARDWARE

H Cam Lock 15/12 x4

COMPONENTS

1 Left Side Panel x1

2 Right Side Panel x1

4 Left Front Rail Panel Bottom x1

5 Right Front Rail Panel Bottom x1

6 Left Back Rail Panel Bottom x1

7 Right Back Rail Panel Bottom x1

18 Back Support Panel x2

6.1 Connect **Left Front Rail Panel Bottom (4)** and **Left Back Rail Panel Bottom (6)** to **Left Side Panel (1)** by inserting **Cam Lock (H)** to the corresponding holes. Connect **Back Support Panel (18)** to **Left Side Panel (1)** by connecting **Wood Dowel (F)** to the corresponding holes.

6.2 Connect **Right Front Rail Panel Bottom (5)** and **Right Back Rail Panel Bottom (7)** to **Right Side Panel (2)** by inserting **Cam Lock (H)** to the corresponding holes. Connect **Back Support Panel (18)** to **Right Side Panel (1)** by connecting **Wood Dowel (F)** to the corresponding holes.

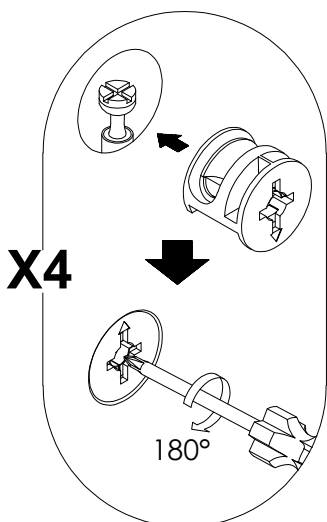
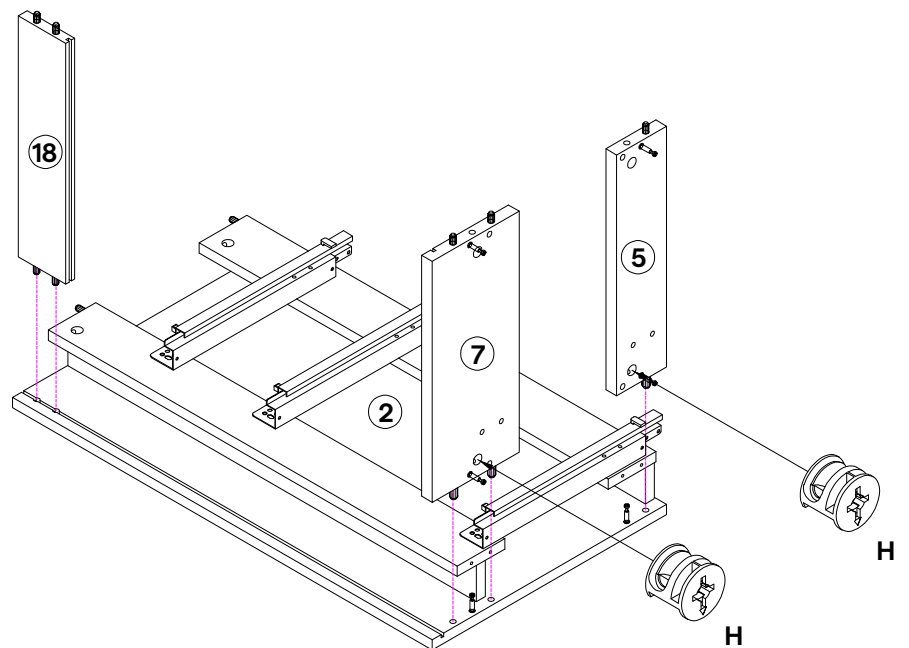
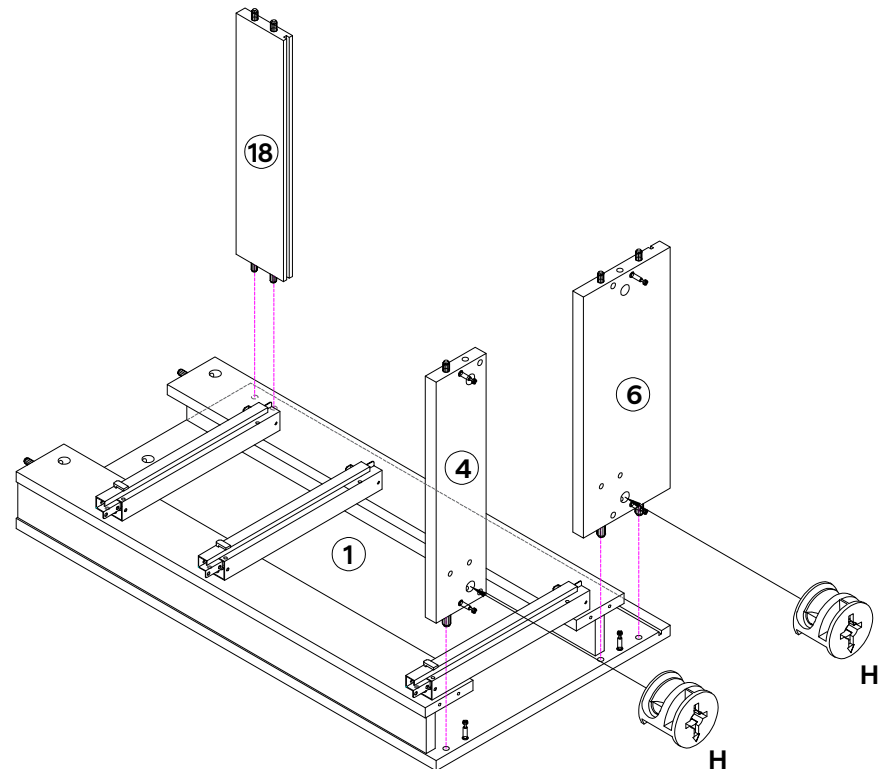

HARDWARE

D Screw M6 x 40mm x8

COMPONENTS

1 Left Side Panel x1

2 Right Side Panel x1

4 Left Front Rail Panel Bottom x1

5 Right Front Rail Panel Bottom x1

6 Left Back Rail Panel Bottom x1

7 Right Back Rail Panel Bottom x1

10 Left Side Rail Panel x1

11 Right Side Rail Panel x1

12 Left Side Support Panel x1

13 Right Side Support Panel x1

TOOLS

R Allen Key

7.1 Secure **Right Front Rail Panel Bottom (5)** and **Right Back Rail Panel Bottom (7)** to **Right Side Rail Panel (11)** and **Right Side Support Panel (13)** with **Screw (D)** using the provided **Allen Key (R)**.

7.2 Secure **Left Front Rail Panel Bottom (4)** and **Left Back Rail Panel Bottom (6)** to **Left Side Rail Panel (10)** and **Left Side Support Panel (12)** with **Screw (D)** using the provided **Allen Key (R)**.

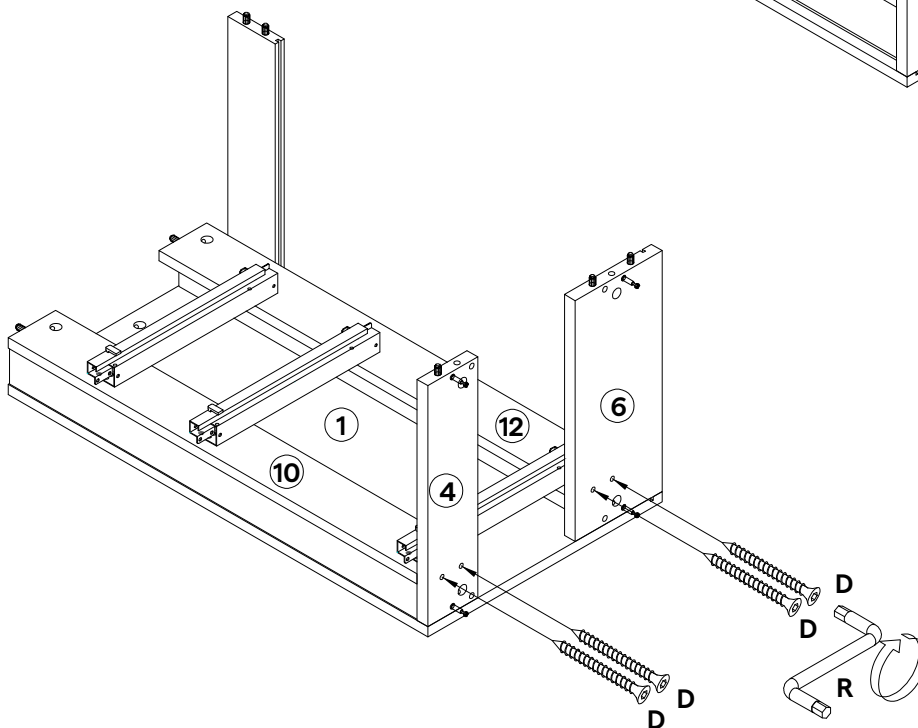
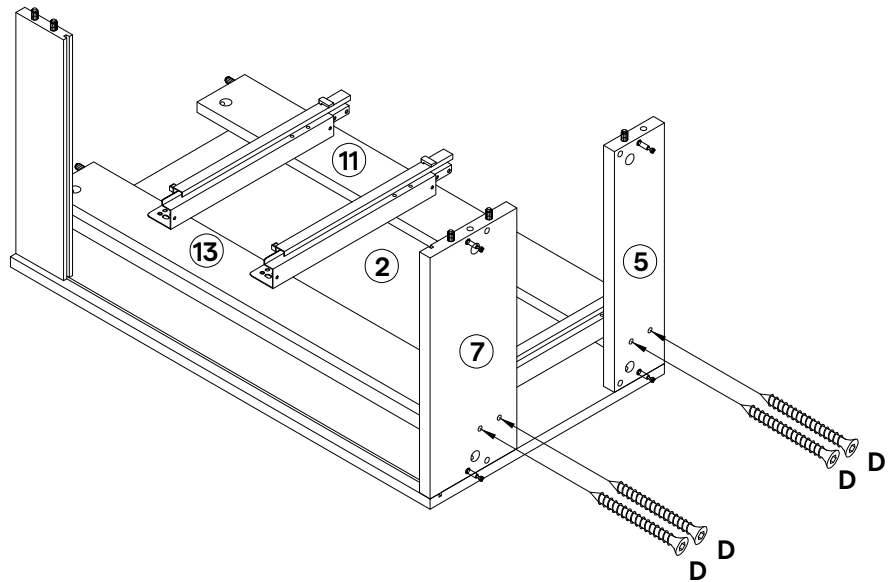

COMPONENTS

1	Left Side Panel	x1
2	Right Side Panel	x1
6	Left Back Rail Panel Bottom	x1
7	Right Back Rail Panel Bottom	x1
18	Back Support Panel	x2
38	Back Panel	x2

8.1 Slot the **Back Panel (38)** into the body.

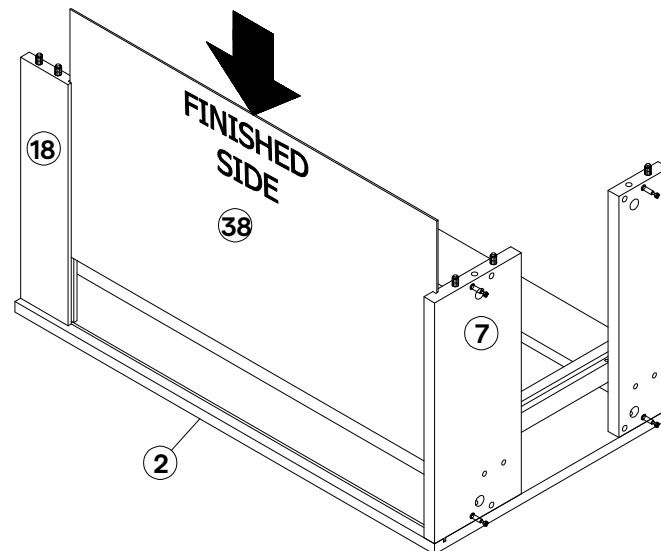
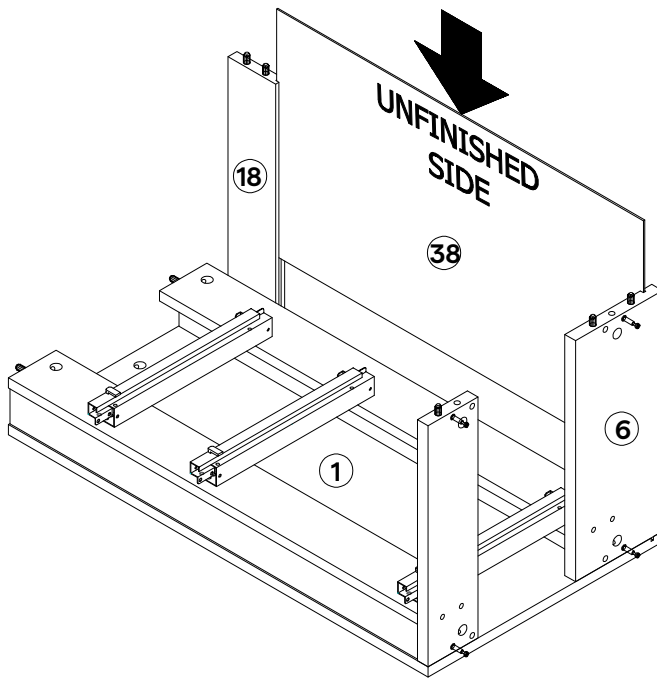

HARDWARE

- C** Screw M6 x 9mm x18
- M1** Push Open Drawer Slide CR (300mm) x2
- M2** Push Open Drawer Slide CL (300mm) x2
- N1** Push Open Drawer Slide CR (350mm) x1
- N2** Push Open Drawer Slide CL (350mm) x1

COMPONENTS

- 8** Left Partition Panel x1
- 9** Right Partition Panel x1

9.1 Attach Push Open Drawer Slide CR (M1) and Push Open Drawer Slide CR (N1) to the left side of Left Partition Panel (8) using Screw (C).

9.2 Attach Push Open Drawer Slide CL (M2) and Push Open Drawer Slide CL (N2) to the right side of Right Partition Panel (9) using Screw (C).

ensure the push open drawer slide are facing the correct direction according to the illustration.

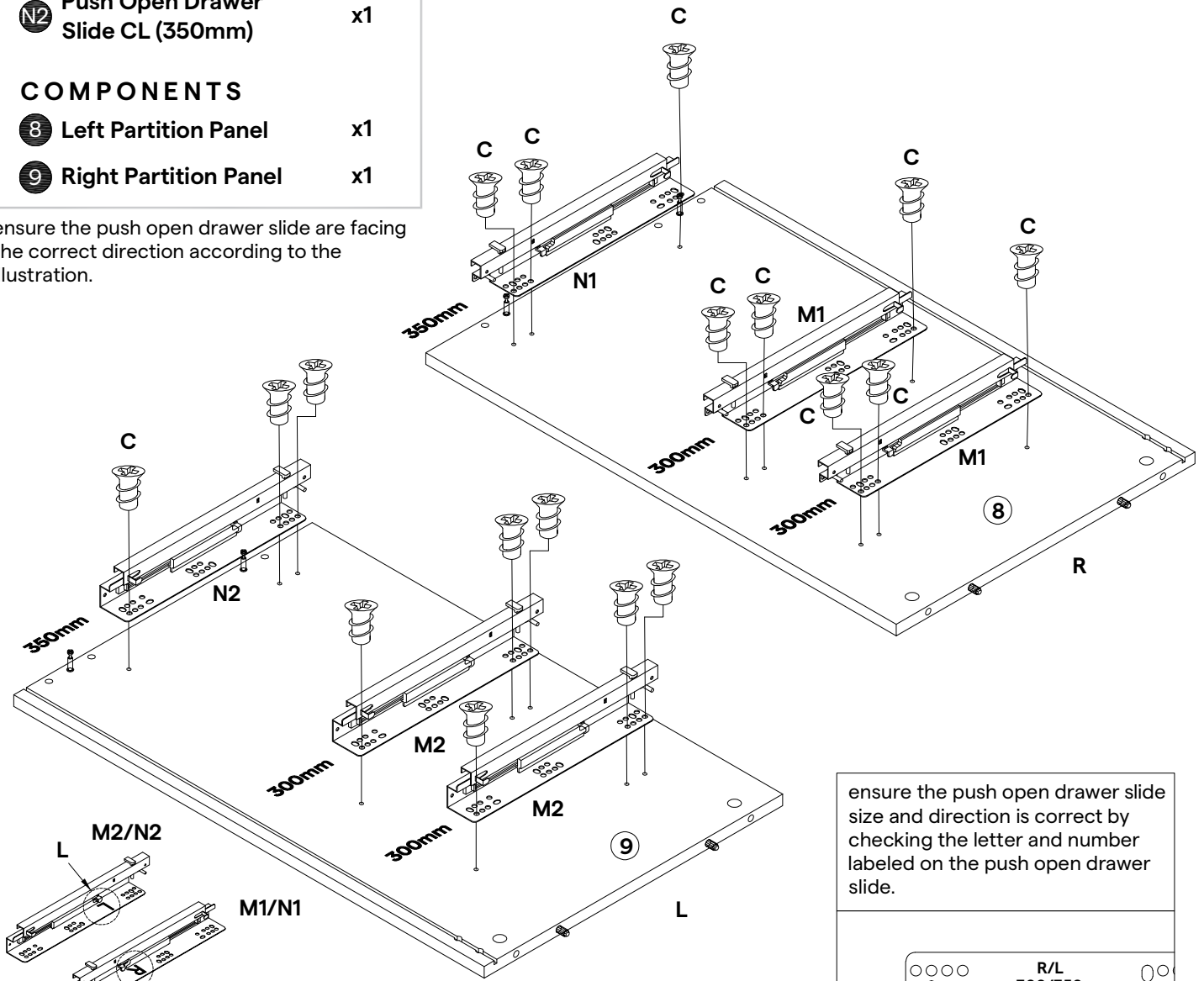

ensure the push open drawer slide size and direction is correct by checking the letter and number labeled on the push open drawer slide.

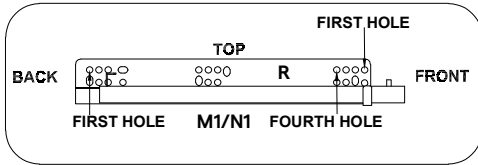
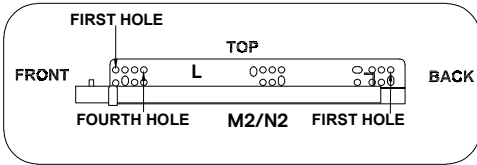
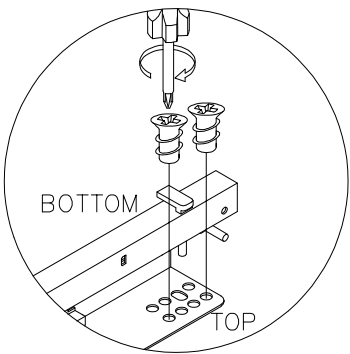
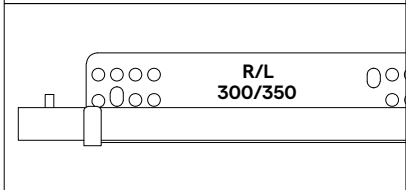

SECURE SCREWS ONLY AT THE DESIGNATED HOLES POSITIONS INDICATED IN THE INSTALLATION GUIDE. IMPROPER PLACEMENT MAY RESULT UNEVEN DRAWER GAPS, MISALIGNED FRONT, OR UNEVEN DRAWER TRACKING, AFFECTING BOTH FUNCTION & APPEARANCE

HARDWARE

- A** Screw M3 x 16mm (RB) x2
- C** Screw M6 x 9mm x4
- K1** Drawer Slide CR (300mm) x1
- K2** Drawer Slide CL (300mm) x1

COMPONENTS

- 8** Left Partition Panel x1
- 9** Right Partition Panel x1

ensure the drawer slide are facing the correct direction according to the illustration.

10.1 Attach **Drawer Slide CR (K1)** to the left side of **Right Partition Panel (9)**.

10.2 Attach **Drawer Slide CL (K2)** to the right side of **Left Partition Panel (8)**.

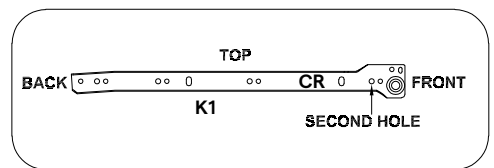
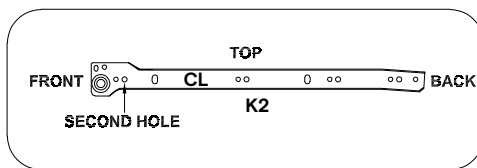
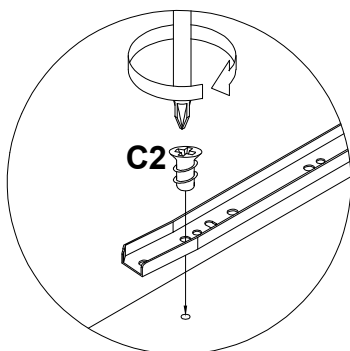
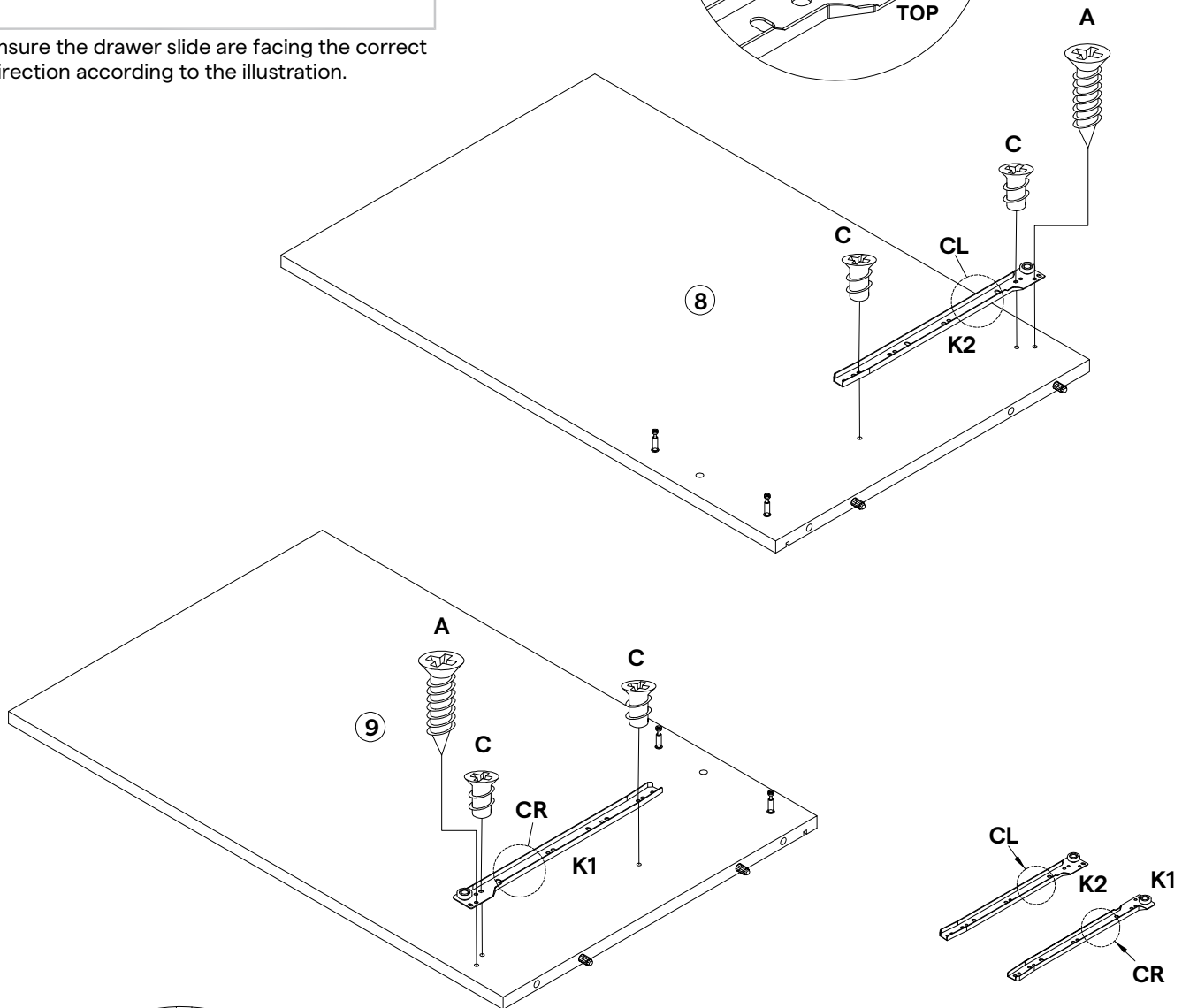
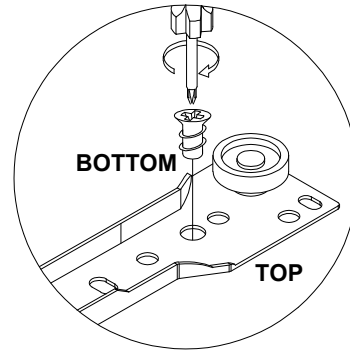

SECURE SCREWS ONLY AT THE DESIGNATED HOLES POSITIONS INDICATED IN THE INSTALLATION GUIDE. IMPROPER PLACEMENT MAY RESULT UNEVEN DRAWER GAPS, MISALIGNED FRONT, OR UNEVEN DRAWER TRACKING, AFFECTING BOTH FUNCTION & APPEARANCE

HARDWARE

H Cam Lock 15/12 x4

COMPONENTS

4 Left Front Rail Panel Bottom x1

5 Right Front Rail Panel Bottom x1

6 Left Back Rail Panel Bottom x1

7 Right Back Rail Panel Bottom x1

8 Left Partition Panel x1

9 Right Partition Panel x1

18 Back Support Panel x2

10.1 Connect **Left Partition Panel (8)** to **Left Front Rail Panel Bottom (4)**, **Left Back Rail Panel Bottom (6)**, **Back Support Panel (18)** by inserting **Cam Lock (H)** to the corresponding holes.

10.2 Connect **Right Partition Panel (9)** to **Right Front Rail Panel Bottom (5)**, **Right Back Rail Panel Bottom (7)**, **Back Support Panel (18)** by inserting **Cam Lock (H)** to the corresponding holes.

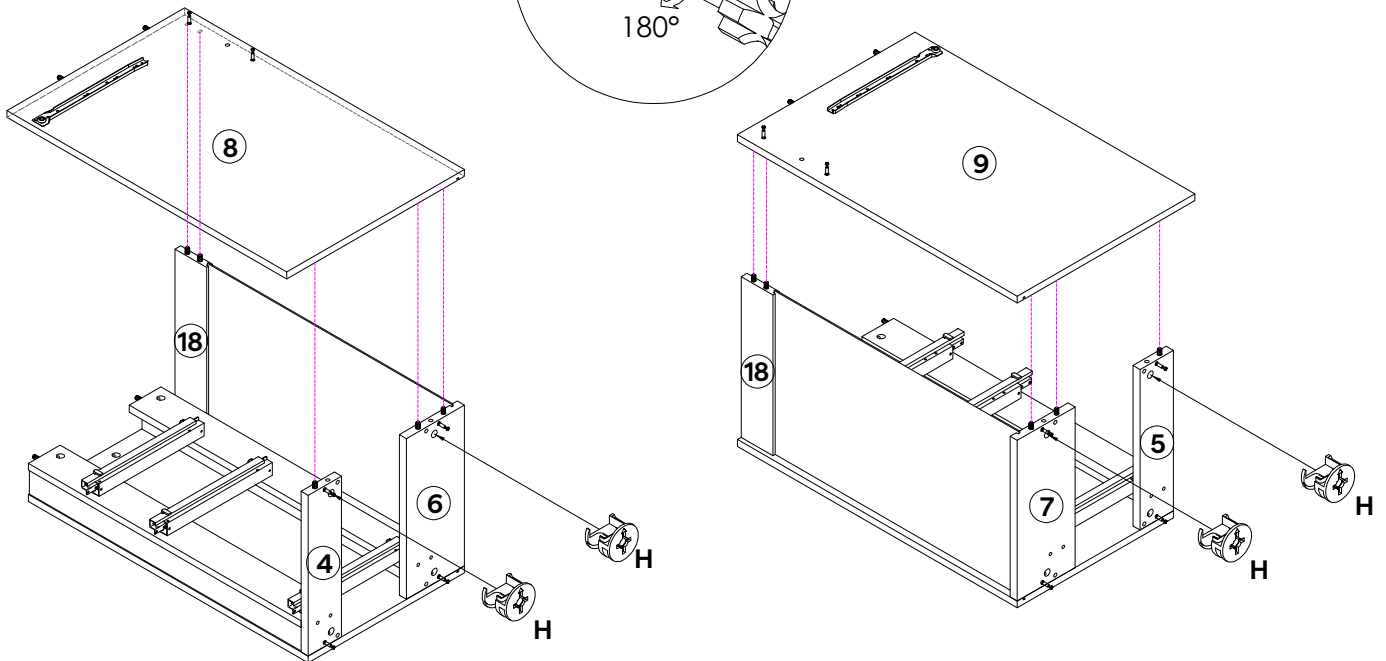
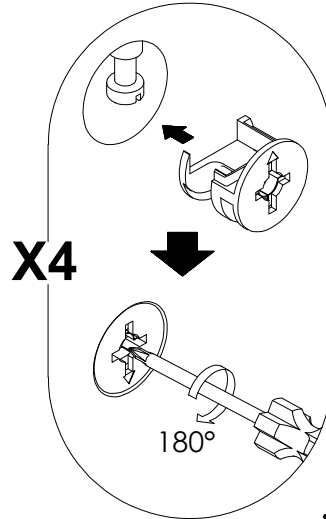

STEP 11

HARDWARE

F Wood Dowel Ø8 x 25 mm x8

COMPONENTS

19 Left Bottom Frame x1

20 Right Bottom Frame x1

11.1 Insert **Wood Dowel (F)** into the innermost pre-drilled holes on the top side of **Left Bottom Frame (19)** and **Right Bottom Frame (20)**.

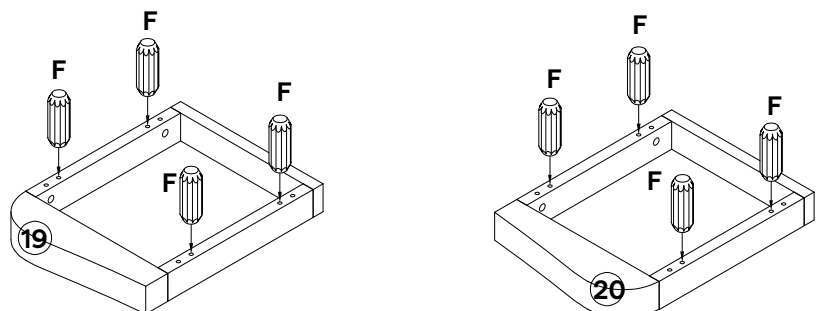

HARDWARE

H Cam Lock 15/12 x8

COMPONENTS

4 Left Front Rail Panel Bottom x1

5 Right Front Rail Panel Bottom x1

6 Left Back Rail Panel Bottom x1

7 Right Back Rail Panel Bottom x1

19 Left Bottom Frame x1

20 Right Bottom Frame x1

12.1 Connect **Left Bottom Frame (19)** to **Left Front Rail Panel Bottom (4)** and **Left Back Rail Panel Bottom (6)** by inserting **Cam Lock (H)** to the corresponding holes.

12.2 Connect **Right Bottom Frame (20)** to **Right Front Rail Panel Bottom (5)** and **Right Back Rail Panel Bottom (7)** by inserting **Cam Lock (H)** to the corresponding holes.

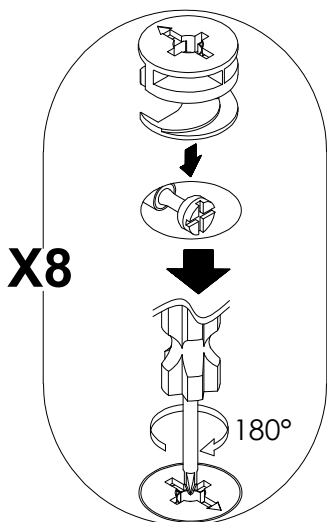
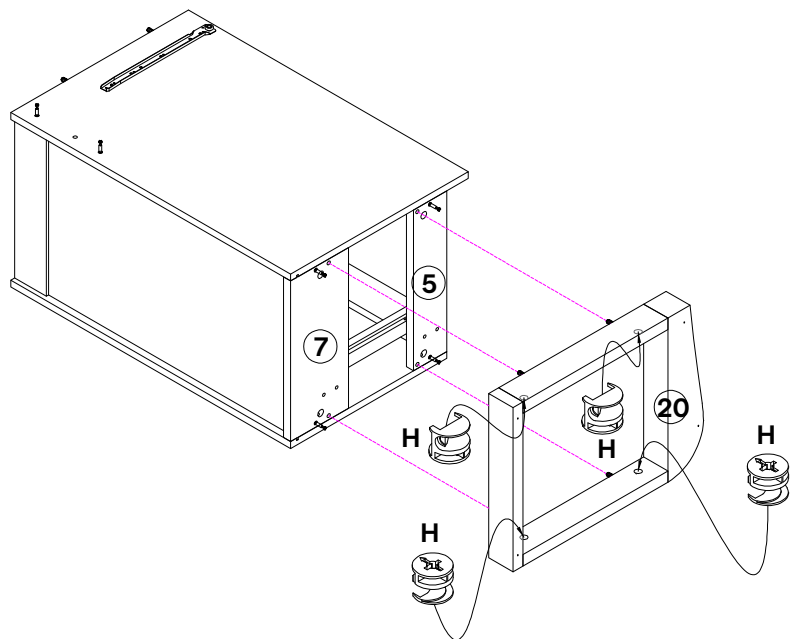
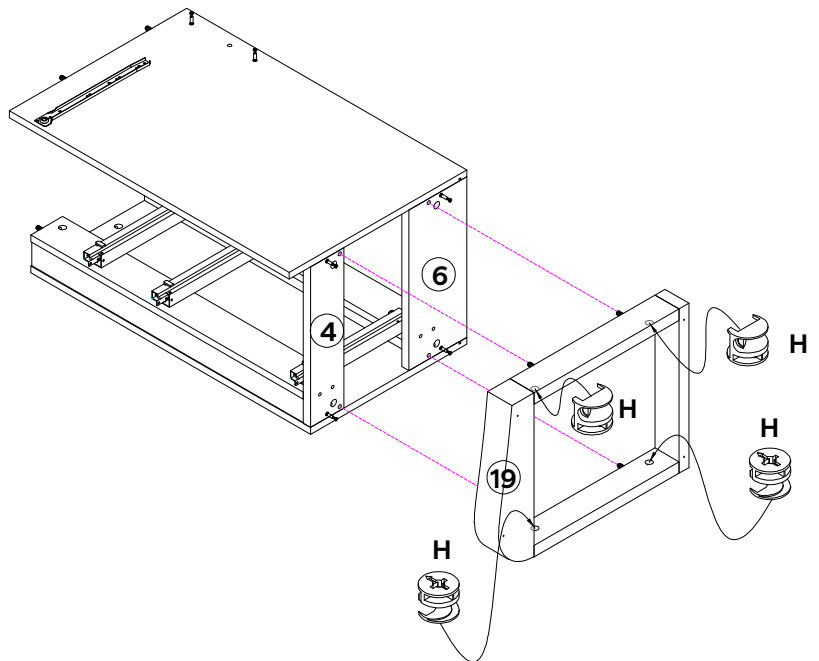

HARDWARE**Q** Plastic Leg Stud x8**COMPONENTS****19** Left Bottom Frame x1**20** Right Bottom Frame x1

13.1 Insert **Plastic Leg Stud (Q)** to the bottom side of **Left Bottom Frame (19)** and **Right Bottom Frame (20)**.

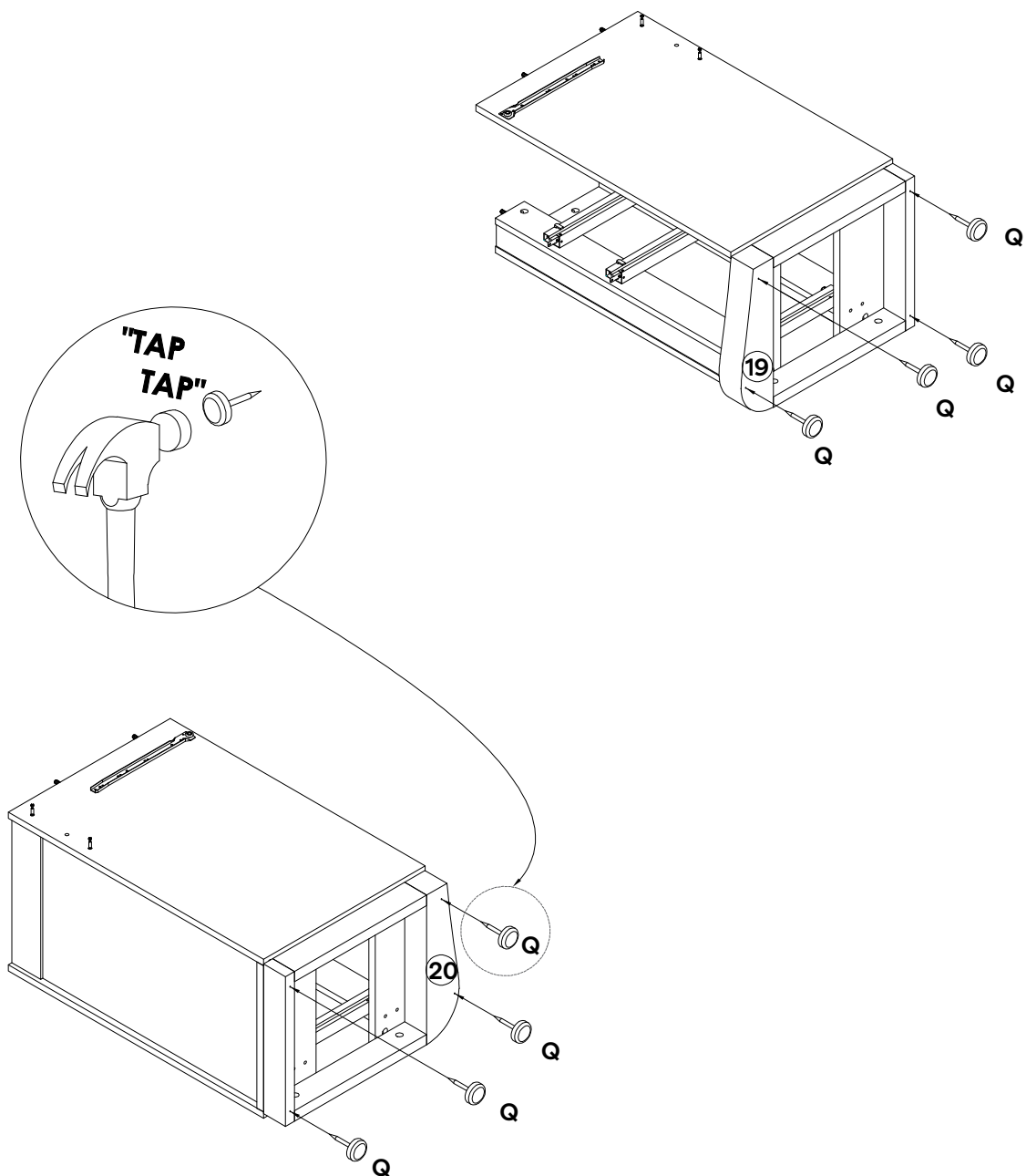

HARDWARE

H Cam Lock 15/12 x4

COMPONENTS

8 Left Partition Panel x1

9 Right Partition Panel x1

15 Center Back Support Panel x1

14.1 Connect **Center Back Support Panel (15)** to **Left Partition Panel (8)** and **Right Partition Panel (9)** by inserting **Cam Lock (H)** into the corresponding holes.

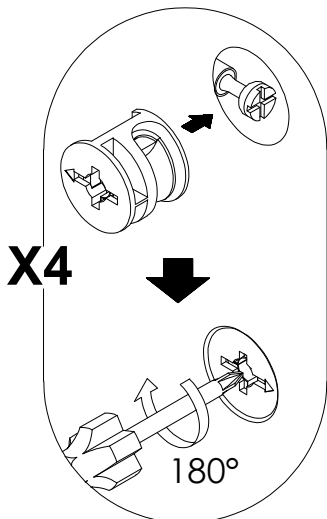
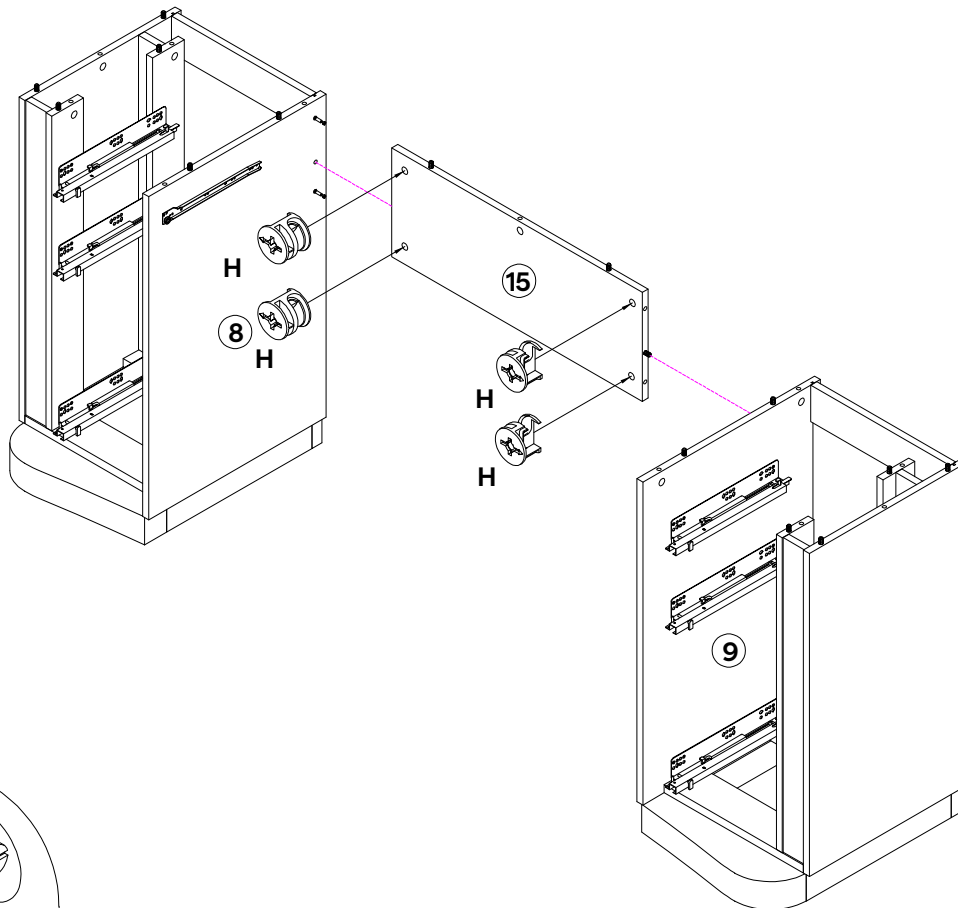

HARDWARE**G** Cam Bolt 20 x 5 mm x11**COMPONENTS****3** Top Panel x1

15.1 Insert **Cam Bolt (G)** into innermost pre-drilled holes on the bottom side of **Top Panel (3)**.

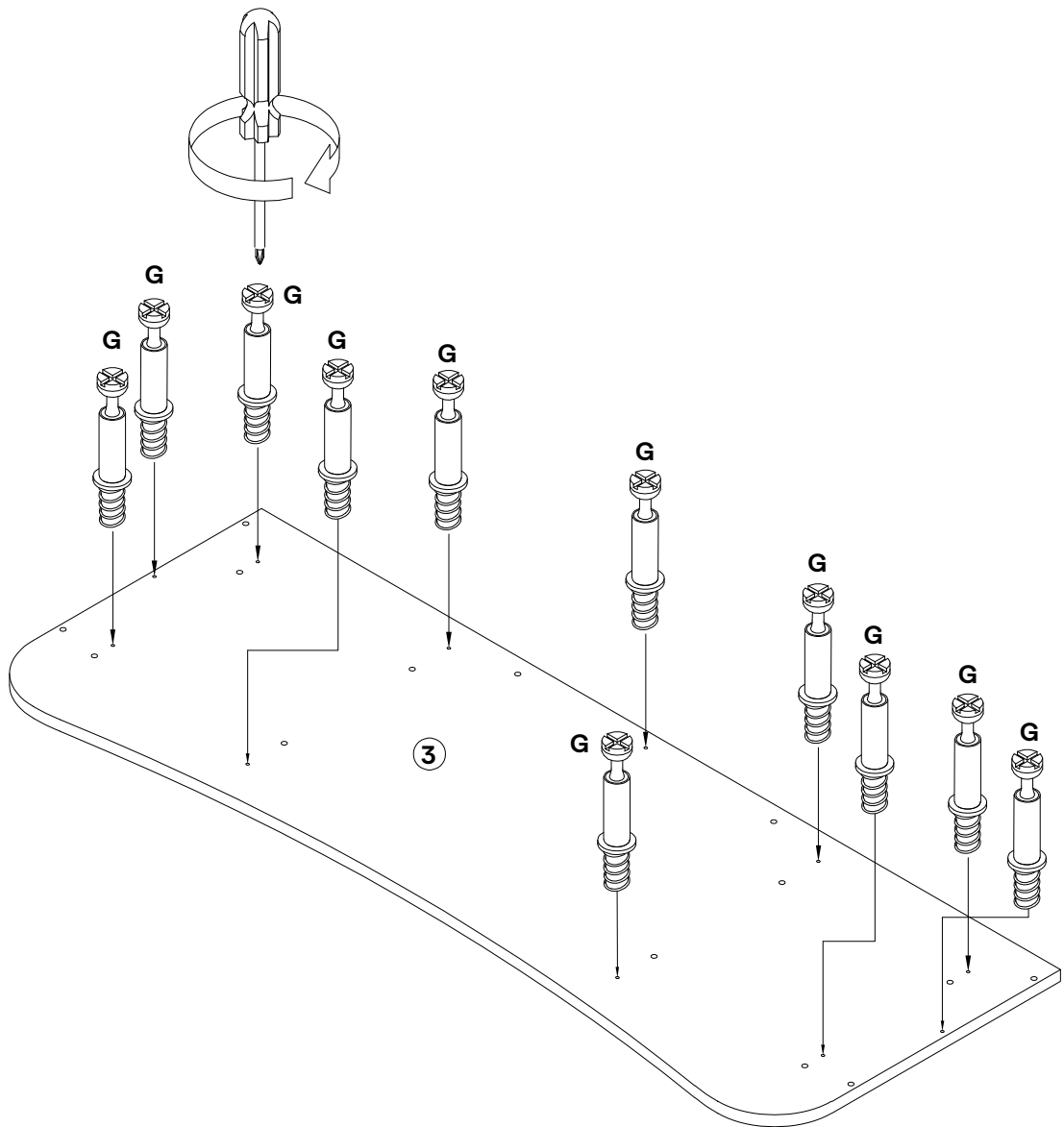

HARDWARE

H Cam Lock 15/12 x11

COMPONENTS

1 Left Side Panel x1
2 Right Side Panel x1
3 Top Panel x1
8 Left Partition Panel x1
9 Right Partition Panel x1
10 Left Side Rail Panel x1
11 Right Side Rail Panel x1
12 Left Side Support Panel x1
13 Right Side Support Panel x1
15 Center Back Support Panel x1

16.1 Connect Top Panel (3) to Left Side Panel (1), Right Side Panel (2), Left Partition Panel (8), Right Partition Panel (9), Left Side Rail Panel (10), Right Side Rail Panel (11), Left Side Support Panel (12), Right Side Support Panel (13) and Center Back Support Panel (15) by inserting Cam Lock (H) into the corresponding holes.

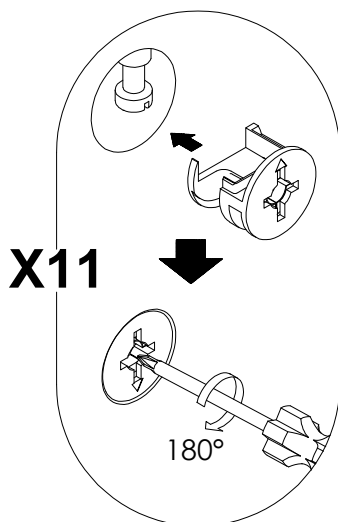
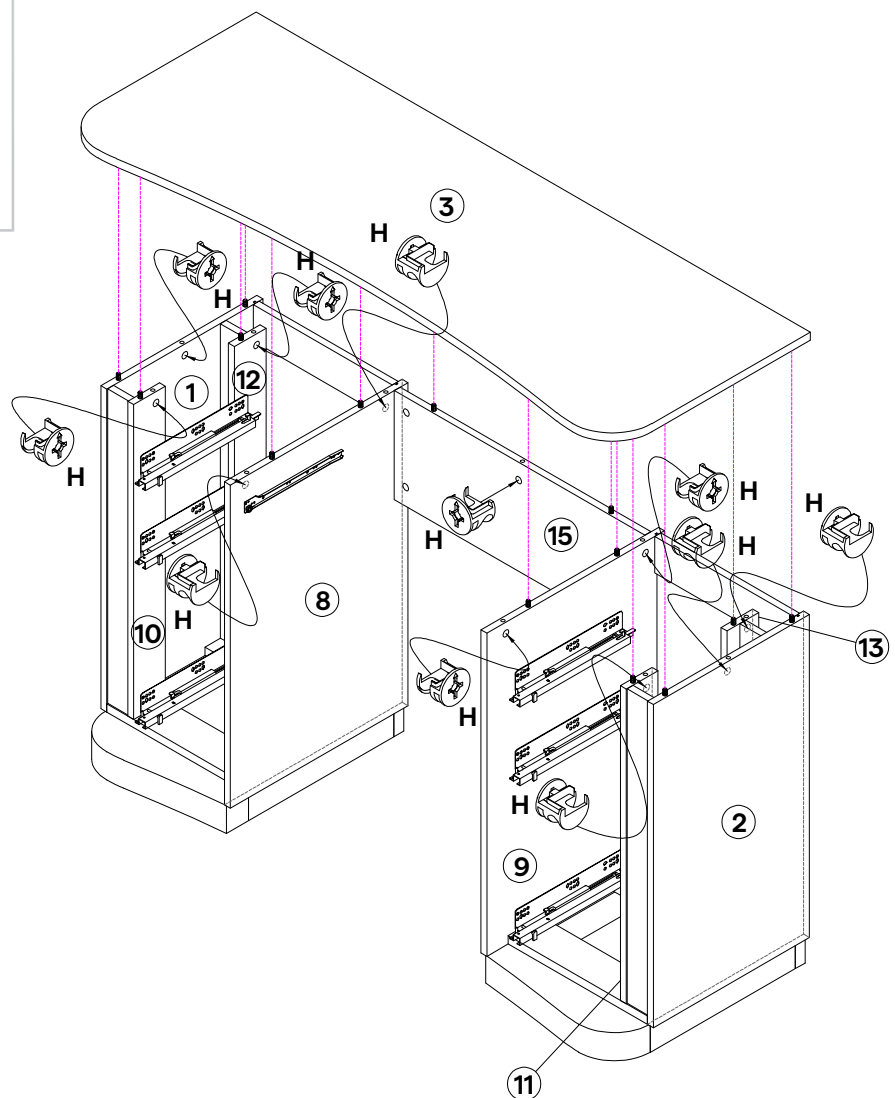

HARDWARE

- E** Wood Dowel Ø6 x 20 mm x12
- G** Cam Bolt 20 x 5 mm x24

COMPONENTS

- 21** Left Drawer Front x2
- 22** Right Drawer Front x2
- 23** Bottom Left Drawer Front x1
- 24** Bottom Right Drawer Front x1
- 25** Left Drawer Left Drawer Side x2
- 26** Right Drawer Right Drawer Side x2
- 27** Right Drawer Left Drawer Side x2
- 28** Left Drawer Right Drawer Side x2
- 29** Bottom Left Drawer Left Drawer Side x1
- 30** Bottom Right Drawer Right Drawer Side x1
- 31** Bottom Right Drawer Left Drawer Side x1
- 32** Bottom Left Drawer Right Drawer Side x1

17.1 Insert **Wood Dowel (E)** into innermost pre-drilled holes on the left edge of **Left Drawer Left Drawer Side (25)**, **Right Drawer Left Drawer Side (27)**, **Bottom Left Drawer Left Drawer Side (29)** and **Bottom Right Drawer Left Drawer Side (31)**, left edge of **Right Drawer Right Drawer Side (26)**, **Left Drawer Right Drawer Side (28)**, **Bottom Right Drawer Right Drawer Side (30)** and **Bottom Left Drawer Right Drawer Side (32)**.

17.2 Insert **Cam Bolt (G)** into innermost pre-drilled holes on the back side of **Left Drawer Front (21)**, **Right Drawer Front (22)**, **Bottom Left Drawer Front (23)** and **Bottom Right Drawer Front (24)**.

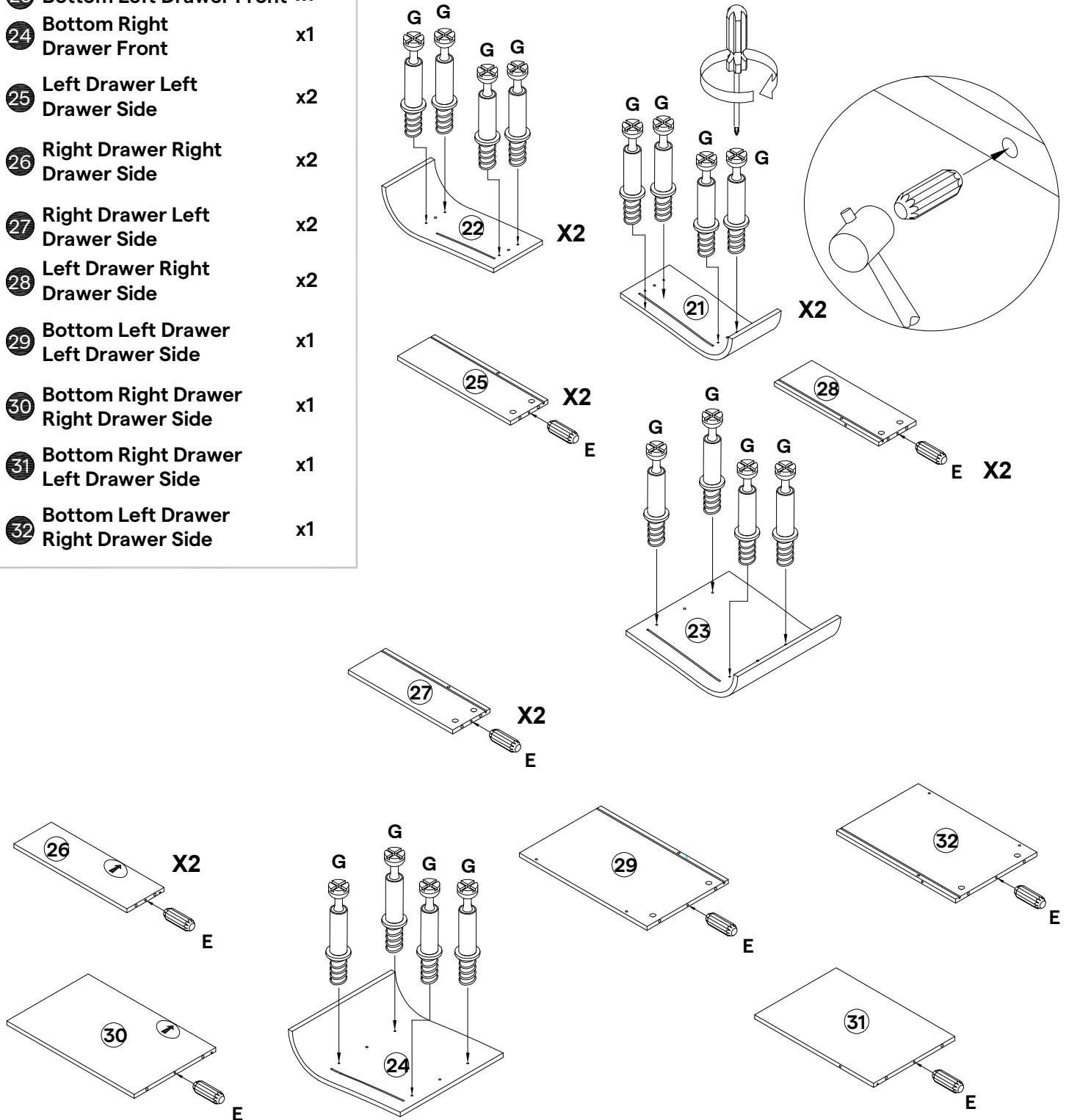

HARDWARE

J Cam Lock 15/10 x16

COMPONENTS

21 Left Drawer Front x2

22 Right Drawer Front x2

25 Left Drawer Left Drawer Side x2

26 Right Drawer Right Drawer Side x2

27 Right Drawer Left Drawer Side x2

28 Left Drawer Right Drawer Side x2

34 Left Drawer Drawer Bottom x2

35 Right Drawer Drawer Bottom x2

18.1 Connect **Left Drawer Left Drawer Side (25)** and **Left Drawer Right Drawer Side (28)** to **Left Drawer Front (21)** by inserting **Cam Lock (J)** into the corresponding holes.

18.2 Slot the **Left Drawer Drawer Bottom (34)** into the drawer body.

18.3 Connect **Right Drawer Right Drawer Side (26)** and **Right Drawer Left Drawer Side (27)** to **Right Drawer Front (22)** by inserting **Cam Lock (J)** into the corresponding holes.

18.4 Slot the **Left Drawer Drawer Bottom (35)** into the drawer body.

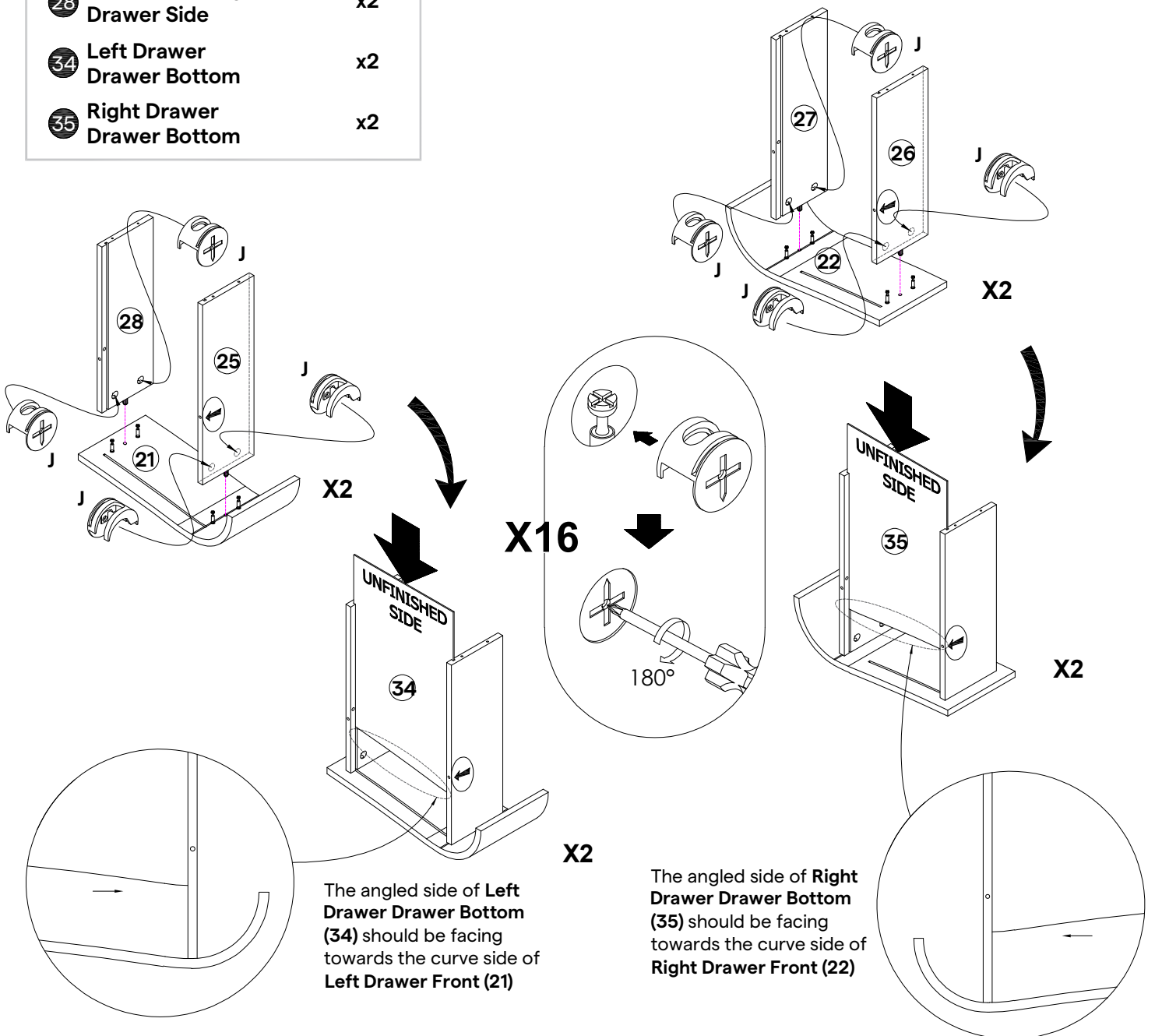

The angled side of **Left Drawer Drawer Bottom (34)** should be facing towards the curve side of **Left Drawer Front (21)**

The angled side of **Right Drawer Drawer Bottom (35)** should be facing towards the curve side of **Right Drawer Front (22)**

HARDWARE

D Screw M6 x 40 mm x16

COMPONENTS

25 Left Drawer Left Drawer Side x2

26 Right Drawer Right Drawer Side x2

27 Right Drawer Left Drawer Side x2

28 Left Drawer Right Drawer Side x2

33 Drawer Back x4

TOOLS

R Allen Key

19.1 Secure **Drawer Back (33)** to **Left Drawer Left Drawer Side (25)** and **Left Drawer Right Drawer Side (28)** with **Screw (D)** using the provided **Allen Key (R)**.

19.2 Secure **Drawer Back (33)** to **Right Drawer Right Drawer Side (26)** and **Right Drawer Left Drawer Side (27)** with **Screw (D)** using the provided **Allen Key (R)**.

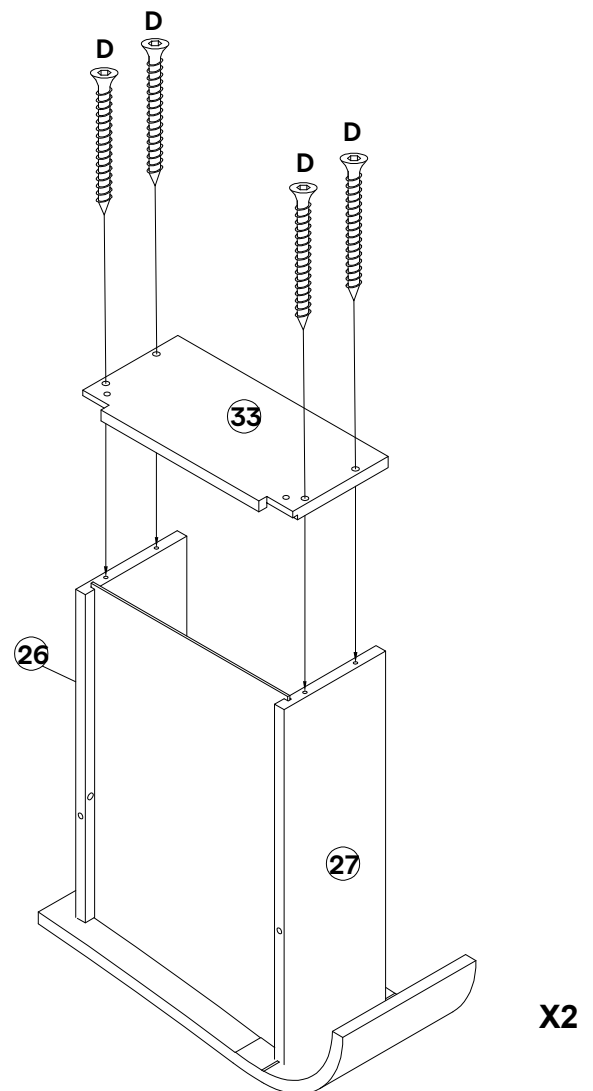
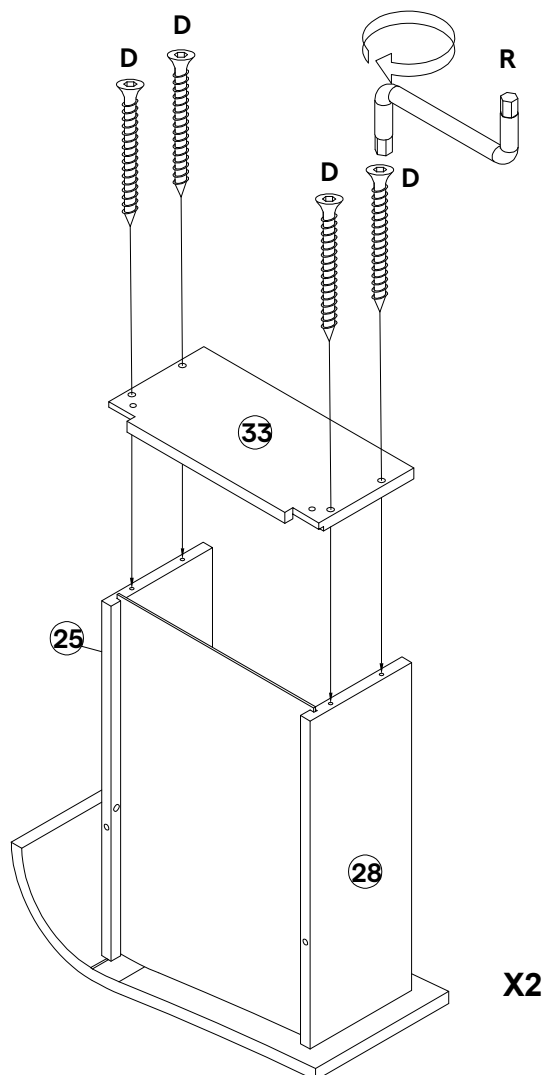

HARDWARE

J Cam Lock 15/10 x8

COMPONENTS

23 Bottom Left Drawer Front x1

24 Bottom Right Drawer Front x1

29 Bottom Left Drawer Left Drawer Side x1

30 Bottom Right Drawer Right Drawer Side x1

31 Bottom Right Drawer Left Drawer Side x1

32 Bottom Left Drawer Right Drawer Side x1

36 Bottom Left Drawer Drawer Bottom x1

37 Bottom Right Drawer Drawer Bottom x1

20.1 Connect **Bottom Left Drawer Left Drawer Side (29)** and **Bottom Left Drawer Right Drawer Side (32)** to **Bottom Left Drawer Front (23)** by inserting **Cam Lock (J)** to the corresponding holes.

20.2 Slot **Bottom Left Drawer Drawer Bottom (36)** into the drawer body.

20.3 Connect **Bottom Right Drawer Right Drawer Side (30)** and **Bottom Right Drawer Left Drawer Side (31)** to **Bottom Right Drawer Front (24)** by inserting **Cam Lock (J)** to the corresponding holes.

20.4 Slot **Bottom Right Drawer Drawer Bottom (37)** into the drawer body.

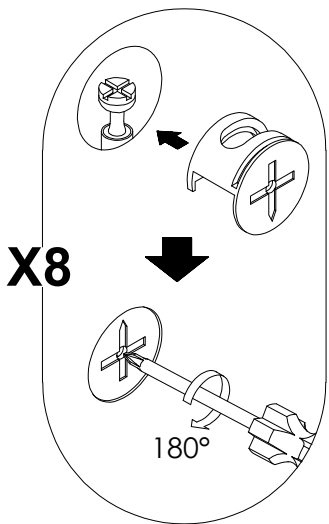

X8

180°

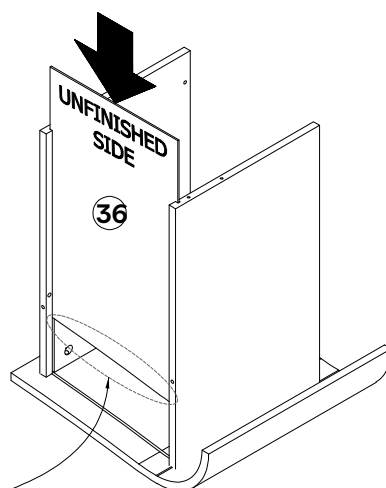
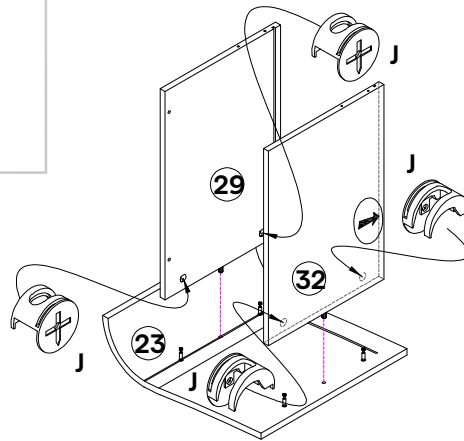

The angled side of **Bottom Left Drawer Drawer Bottom (36)** should be facing towards the curve side of **Bottom Left Drawer Front (23)**

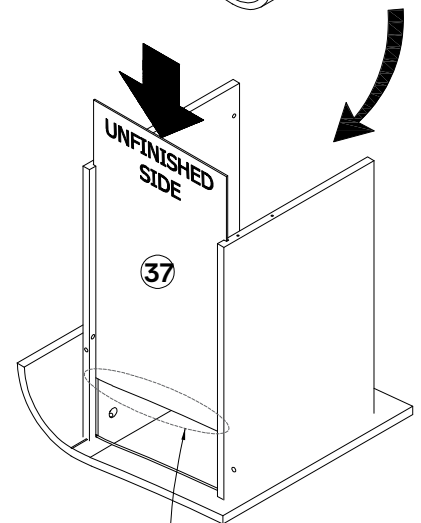
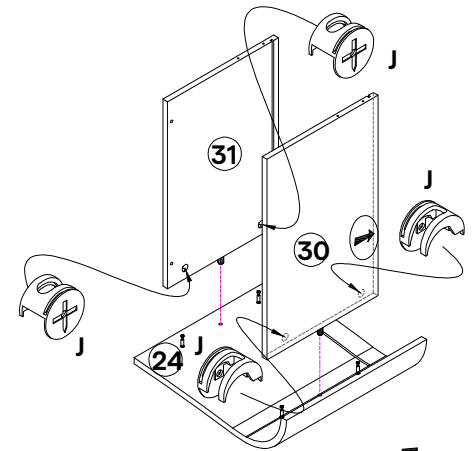

The angled side of **Bottom Right Drawer Drawer Bottom (37)** should be facing towards the curve side of **Bottom Right Drawer Front (24)**

HARDWARE

P Wire Rod (Ø5 x 250) x4

COMPONENTS

29 Bottom Left Drawer Left Drawer Side x1
30 Bottom Right Drawer Right Drawer Side x1
31 Bottom Right Drawer Left Drawer Side x1
32 Bottom Left Drawer Right Drawer Side x1

21.1 Insert **Wire Rod (P)** into the innermost pre-drilled holes on the right side of **Bottom Left Drawer Left Drawer Side (29)** and the left side of **Bottom Left Drawer Right Drawer Side (32)**.

22.1 Insert **Wire Rod (P)** into the innermost pre-drilled holes on the right side of **Bottom Right Drawer Left Drawer Side (31)** and the left side of **Bottom Right Drawer Right Drawer Side (30)**.

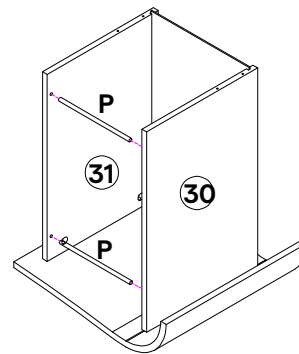
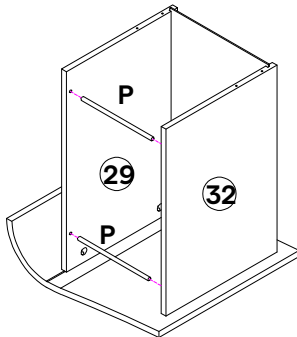

STEP 22

HARDWARE

D Screw M6 x 40 mm x8

COMPONENTS

29 Bottom Left Drawer Left Drawer Side x1
30 Bottom Right Drawer Right Drawer Side x1
31 Bottom Right Drawer Left Drawer Side x1
32 Bottom Left Drawer Right Drawer Side x1
33 Drawer Back x2

TOOLS

R Allen Key

22.1 Secure **Drawer Back (33)** to **Bottom Left Drawer Left Drawer Side (29)** and **Bottom Left Drawer Right Drawer Side (32)** with **Screw (D)** using the provided **Allen Key (R)**.

22.2 Secure **Drawer Back (33)** to **Bottom Right Drawer Right Drawer Side (30)** and **Bottom Right Drawer Left Drawer Side (31)** with **Screw (D)** using the provided **Allen Key (R)**.

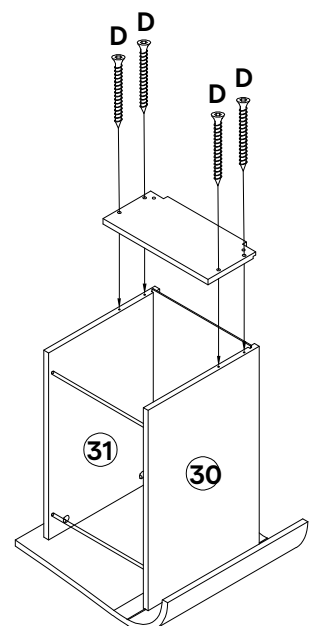
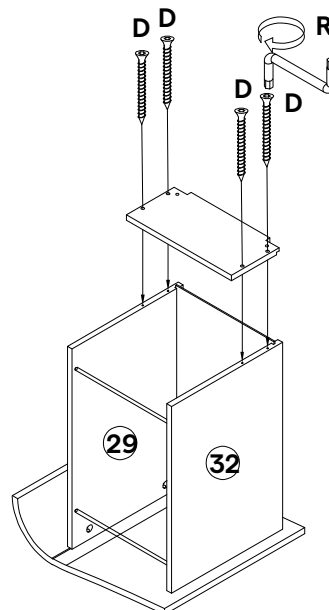

HARDWARE

D Screw M6 x 40 mm x3

COMPONENTS

16 Keyboard Tray x1

17 Back Keyboard Tray x1

TOOLS

R Allen Key

23.1 Secure **Back Keyboard Tray (17)** to **Keyboard Tray (16)** with **Screw (D)** using the provided **Allen Key (R)**.

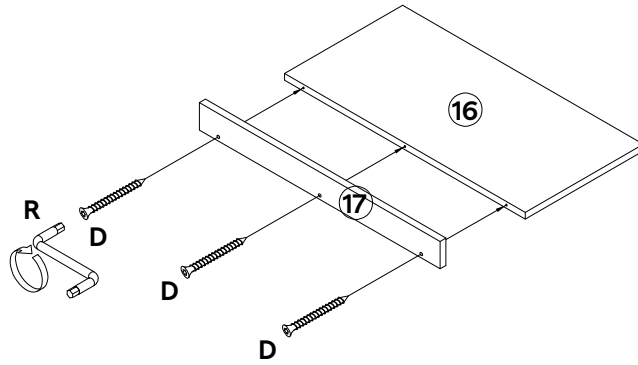

HARDWARE

C Screw m6 x 9 mm x4

L1 Drawer Slide DR (300mm) x1

L2 Drawer Slide DL (300mm) x1

COMPONENTS

16 Keyboard Tray x1

24.1 Attach **Drawer Slide DR (L1)** and **Drawer Slide DL (L2)** with **Screw (C)**.

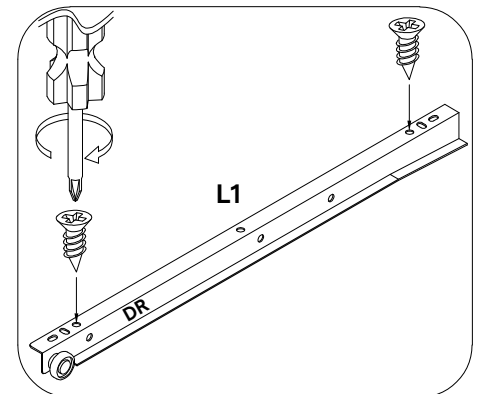
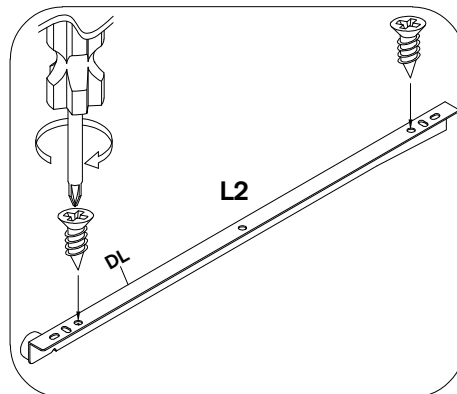
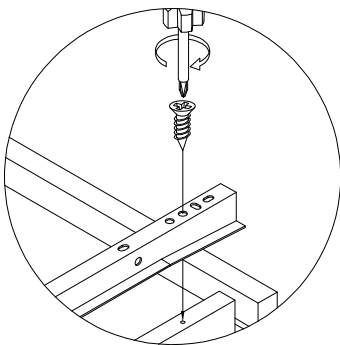
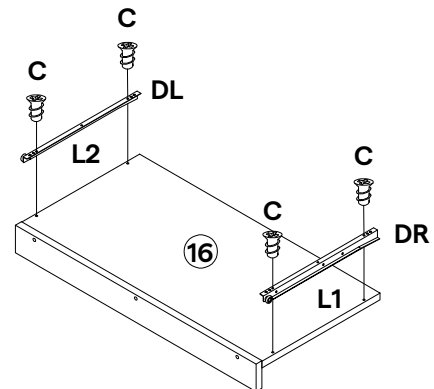

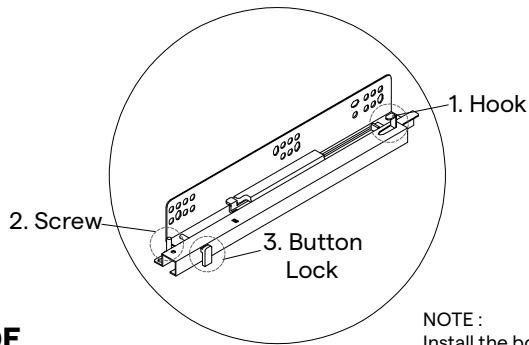

NOTE:
Install the bottom drawer first to make the drawer installation easier.

DRAWER INSTALLATION GUIDE

1. Push and slide out the drawer slide.
2. Unlock the blue colored drawer slide lock.

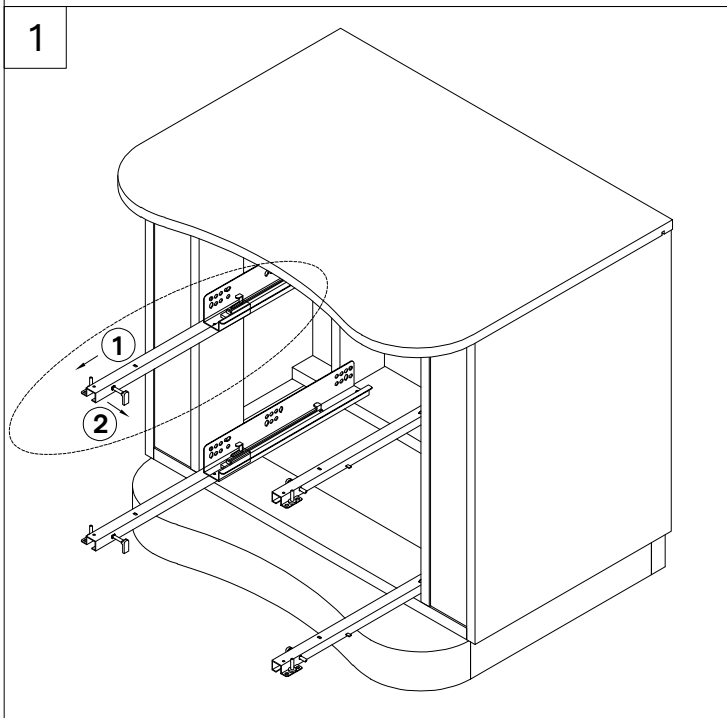

3. Insert the drawer box on the drawer slide.
4. Make sure the back hook of the drawer slide is fitting into the hole at the back of the drawer box right below the arrow sticker.

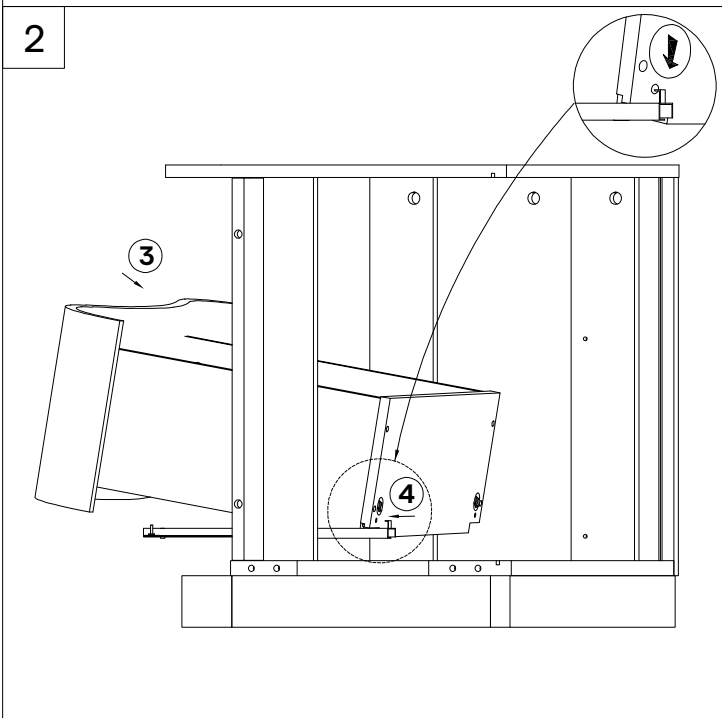

5. The hole for securing the drawer can be found on the bottom side of the side drawer panel below the arrow sticker.
6. Insert the drawer hole into the drawer slide pin by aligning the hole and the pin right below the arrow sticker.

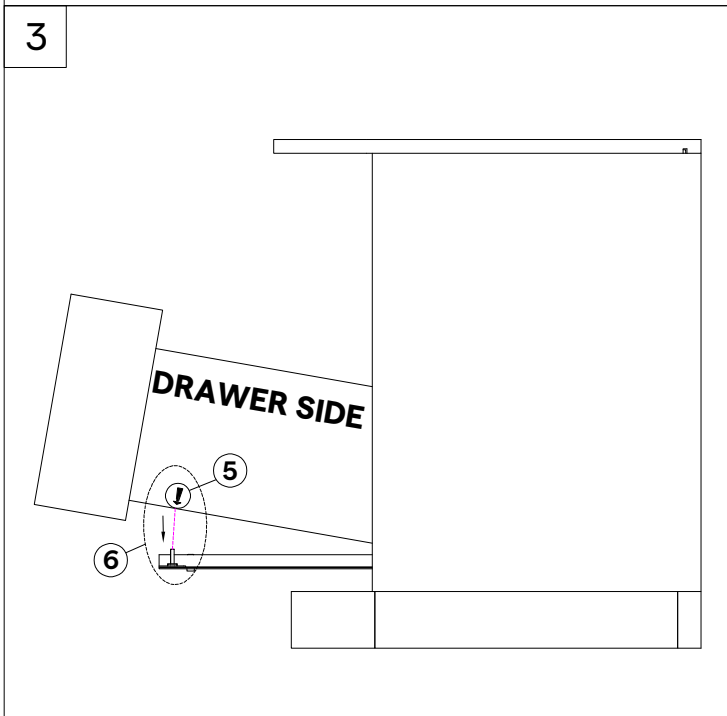

7. Secure the drawer slide to the drawer by pushing the blue colored lock mechanic on the drawer slide.

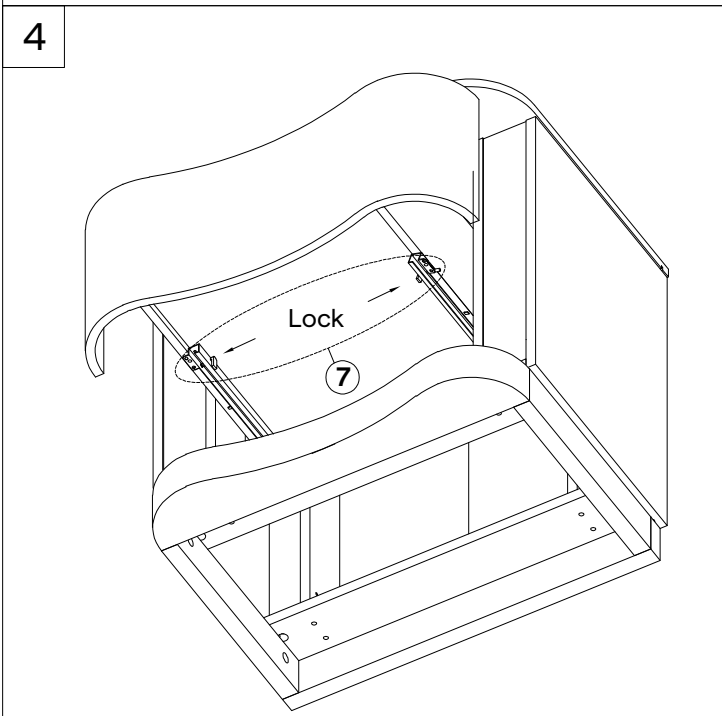

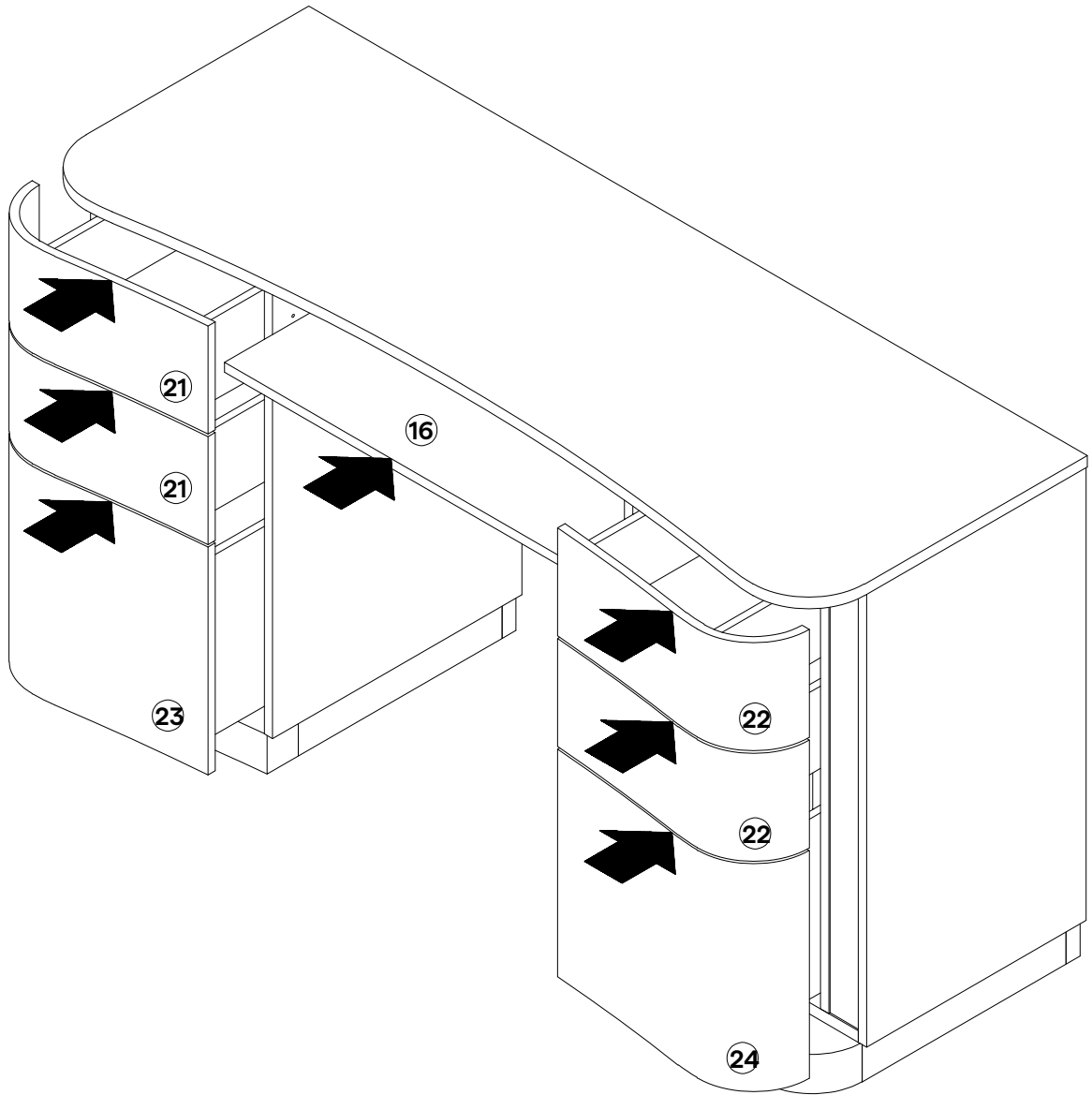

HARDWARE

- B** Screw M3.5 x 15 mm x8
- S** Backply Stopper x8

COMPONENTS

- 38** Back Panel x2

27.1 Attach Backply Stopper (S) to Back Panel (38) with Screw (B).

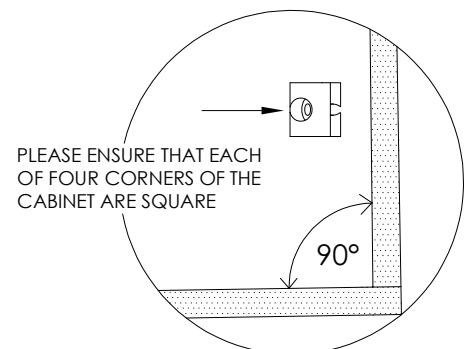
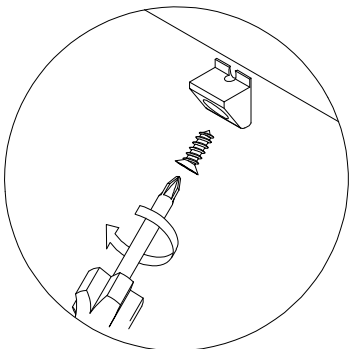
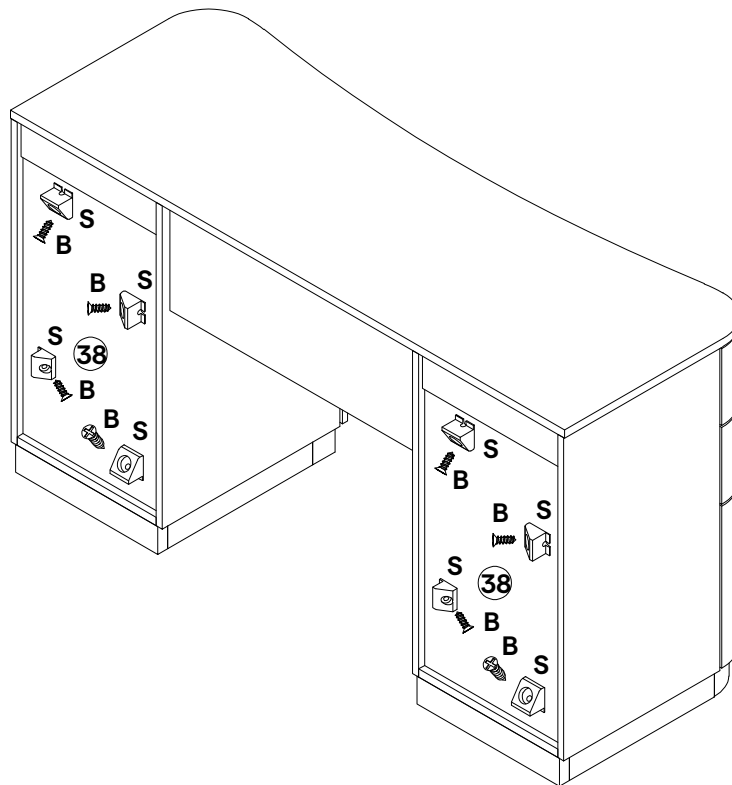

TIPPING RESTRAINTS KIT INSTALLATION GUIDANCE

This tipping restraint is not an earthquake restraint. If you wish to add the extra security of earthquake restraints, they must be purchased and installed separately.

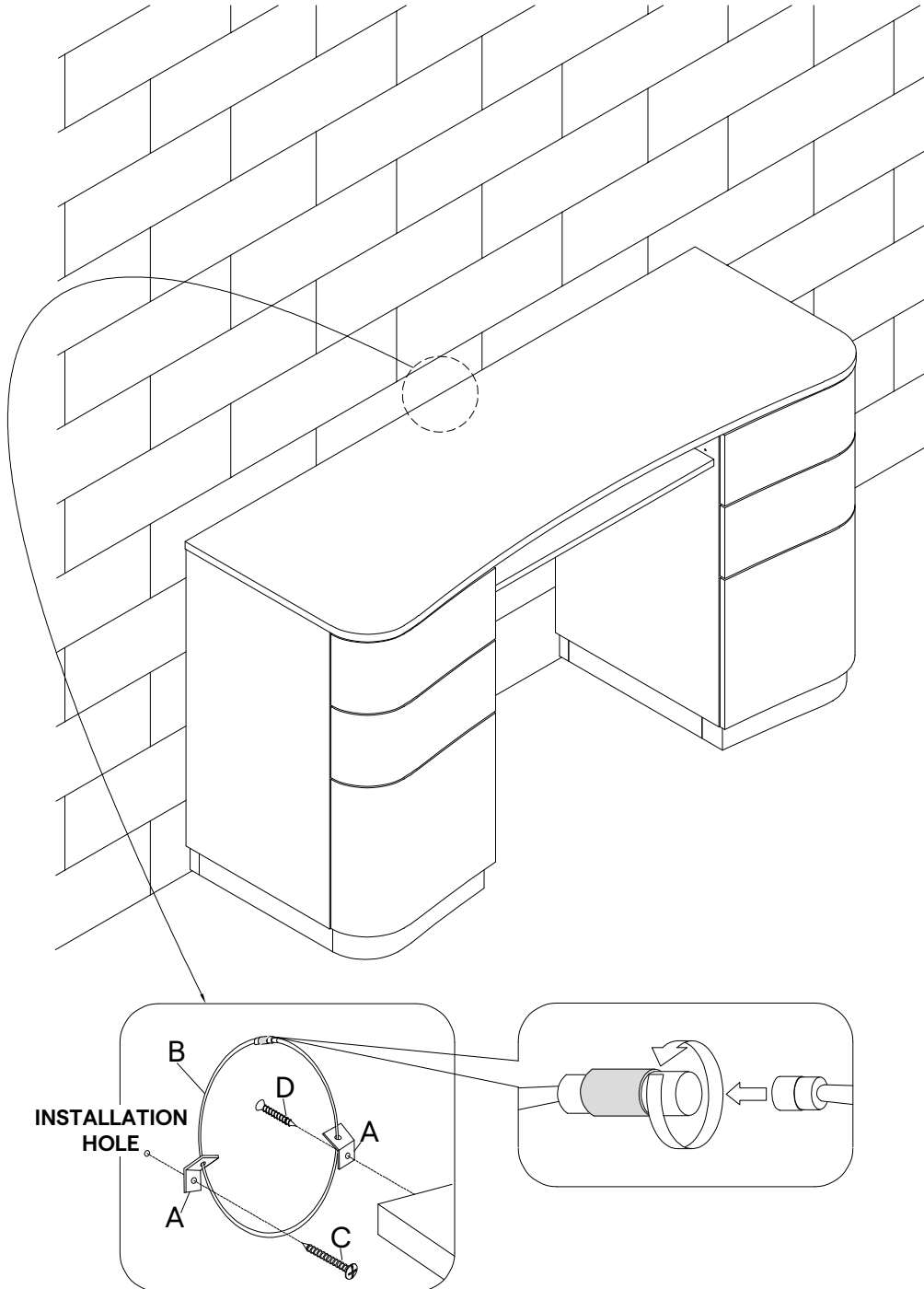
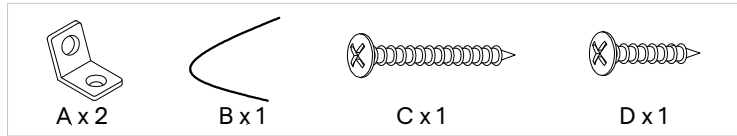

Installation Instructions :

1. Determine where the furniture is to be placed and find the center line of a wooden stud using a stud finder.
2. Drill a 1/8" pilot hole on the wooden stud approximately 3" below the height of unit top.
3. Attach one bracket (A) securely with screw (C) into the pilot hole on the wall.
4. Position the furniture in place and attach the other bracket (A) with screw (D) to the back edge of unit top in line with the bracket (A) on the wall.
5. Put the male end of the steel cable (B) through each bracket. Securely connect both ends together by turning the female connector clockwise.

Great job!

Your desk assembly is complete.

CARING FOR YOUR ITEM

- Indoor use only.
- Not contract grade.
- Clean using a non-abrasive cloth and a mild cleaner.
- Never use harsh chemicals, as they could damage the finish or integrity of the item.

Max 91Kgs/200Lbs

Max 30Kgs/66Lbs

Max 5Kgs/11Lbs

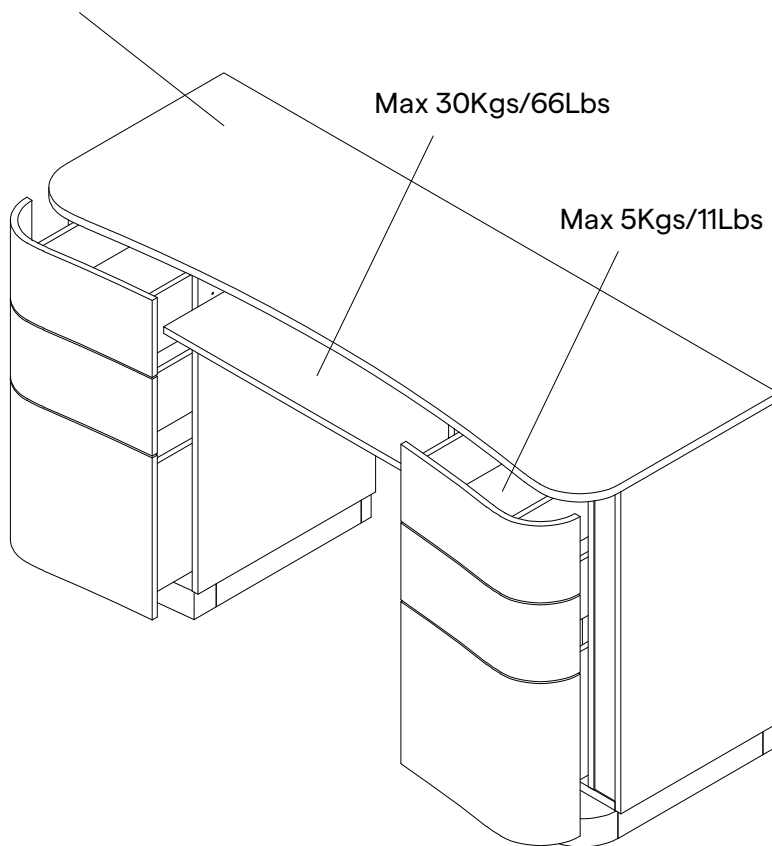

CONNECT WITH US!

Tag us @modway_furniture and #modway
for a chance to be featured.

modway



Questions? Contact us!

609.256.9000
cs@modway.com