

ASSEMBLY INSTRUCTIONS

EEI-5703

V1.01.24.25

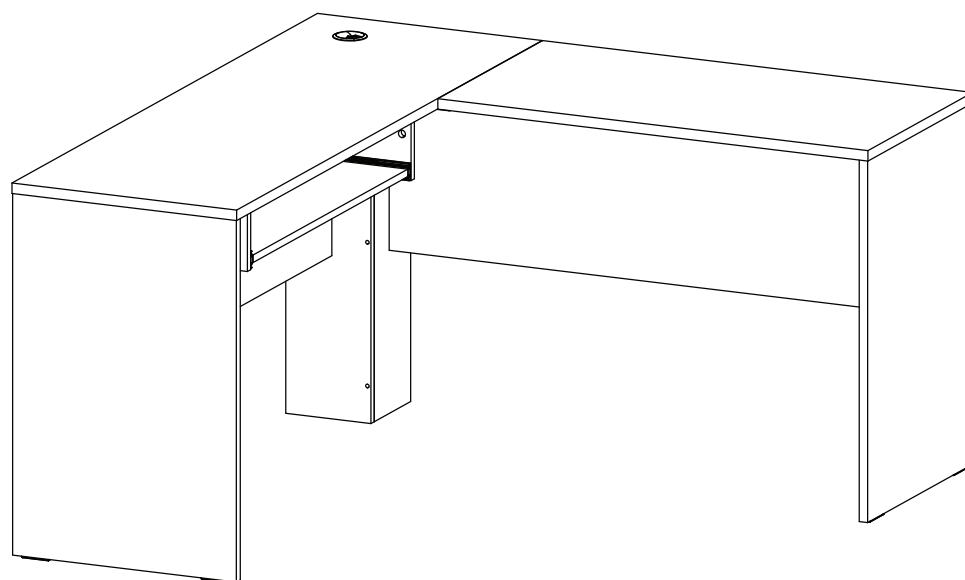
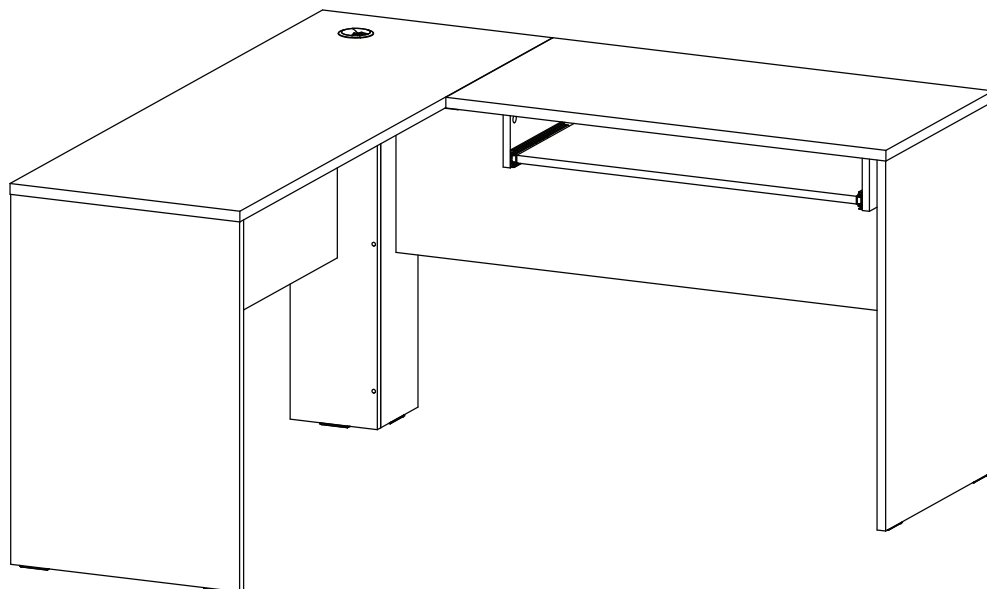

Questions? Contact us!

609.256.9000 • cs@modway.com
www.modway.com

*modway



Read through all of the instructions before starting



Care instructions are listed in the last step of this manual



Approx. 90 minutes assembly time



Make sure you have all parts and components before discarding any packing materials



2 people recommended for assembly

Only use hand tools to assemble this item. Do not use power tools. Do not tighten bolts or screws completely until all hardware is lined up and inserted into the holes.

Do not over-tighten screws and bolts to avoid stripping the hardware or cracking the item.

Assemble your item on a flat, carpeted area, with plenty of space to work. This will prevent damage and scratches to your floors or the item while you're assembling the product.

Keep all components and packaging out of reach of children or animals to avoid risk of choking or suffocation.

Furniture components:

1	Top Board 1	x1	11	Center Board 4	x1
2	Top Board 2	x1			
3	Side Board Left	x1			
4	Side Board Right	x1			
5	Center Board 1	x1			
6	Center Board 2	x1			
7	Center Board 3	x1			
8	Keyboard Drawer Base	x1			
9	Back Board 1	x1			
10	Back Board 2	x1			

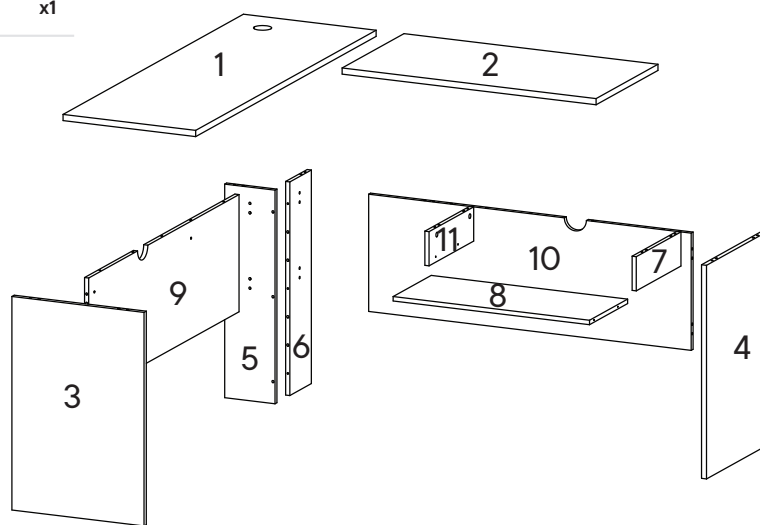

Provided hardware:

A		Cam Bolt Ø6 x 35 mm	x21
B		Cam Lock Ø15 mm	x21
C		Wood Dowel Ø8x30 mm	x27
D		Screw M 6 x 10.5 mm	x8
E		Screw M 4.5 x 12.5 mm	x12
F		Grommet Cover	x1
G		Screw M 7 x 50 mm	x9
H		Allen Key	x2
I		Mending Plates	x2

J		Screw Cap Ø15 mm	x17
K		Screw Cap Ø15 mm	x4
L		Shoe Plate	x6
M		Screw Cap Ø10 mm	x4
RB25A		Keyboard Drawer Runner	x1

What you need:

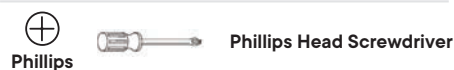

Wait!

Missing parts or hardware? Need assistance?
Contact us before returning your item. We're here to help!
609.256.9000 • cs@modway.com

Step 1

HARDWARE

- C** Wood Dowel Ø8x30 mm x6
- L** Shoe Plate x2

COMPONENTS

- 5** Center Board 1 x1
- 6** Center Board 2 x1

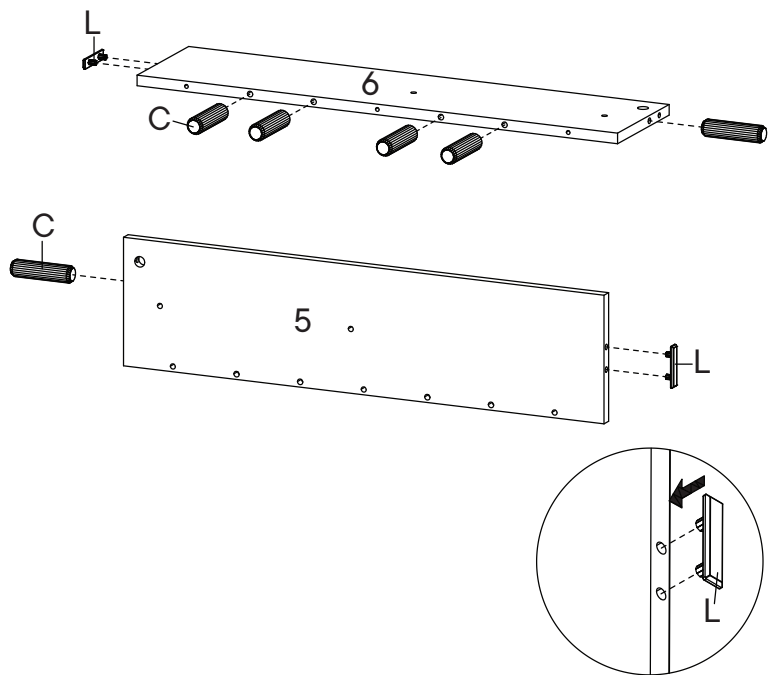

Step 2

HARDWARE

- G** Screw M 7 x 50 mm x3
- H** Allen Key x1

COMPONENTS

- 5** Center Board 1 x1
- 6** Center Board 2 x1

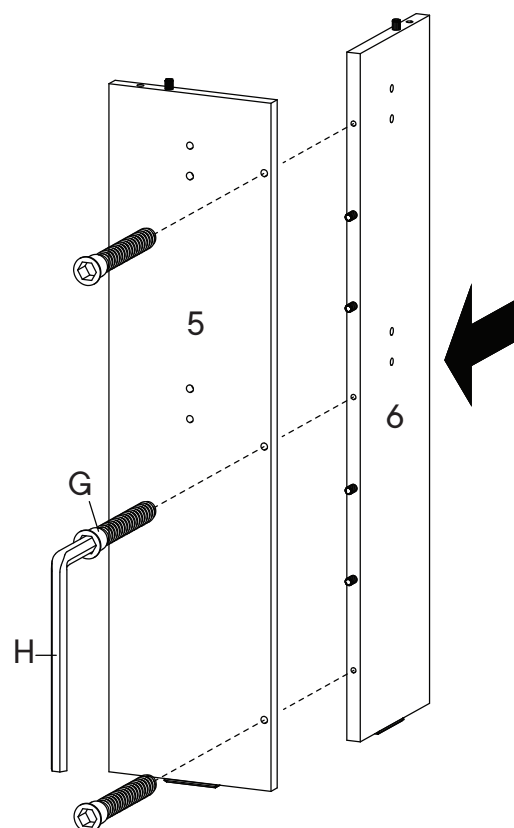
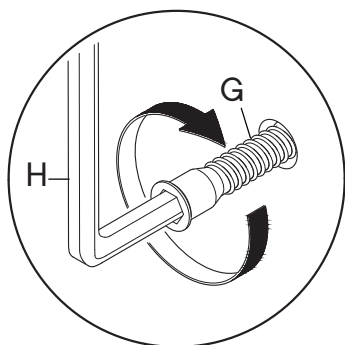

Step 3

HARDWARE

- C** Wood Dowel Ø8x30 mm x4
- D** Screw M 6 x 10.5 mm x4
- RB25A** Keyboard Drawer Runner x1

COMPONENTS

- 7** Center Board 3 x1
- 11** Center Board 4 x1

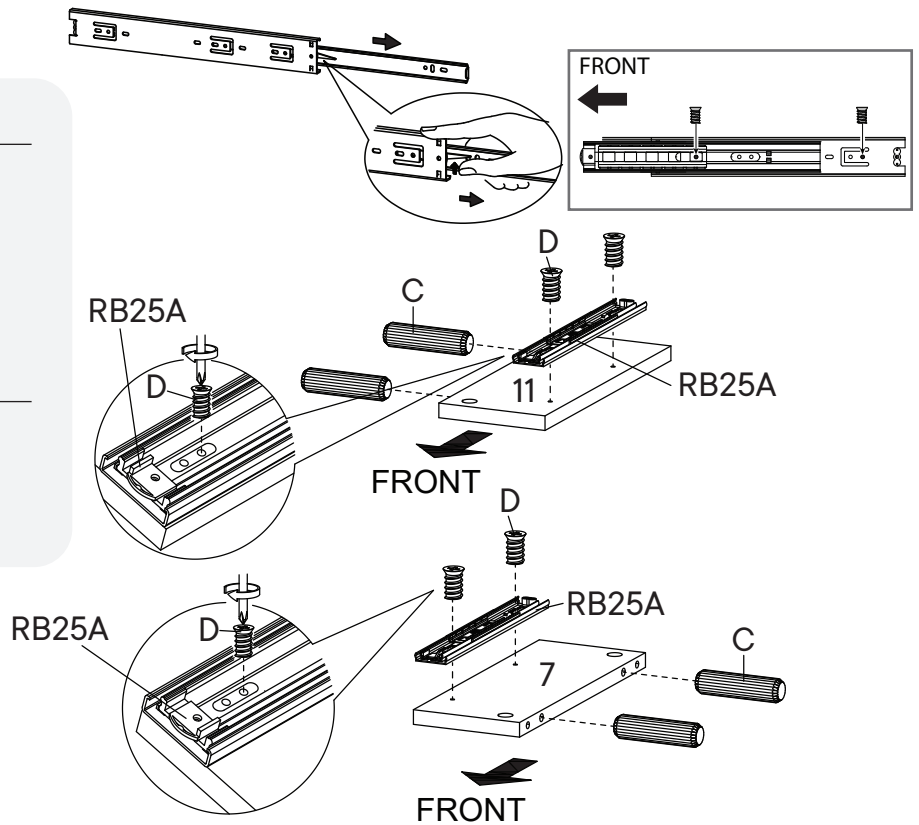

Step 4

HARDWARE

- A** Cam Bolt Ø6 x 35 mm x4
- C** Wood Dowel Ø8x30 mm x17
- L** Shoe Plate x4

COMPONENTS

- 3** Side Board Left x1
- 4** Side Board Right x1
- 9** Back Board 1 x1
- 10** Back Board 2 x1

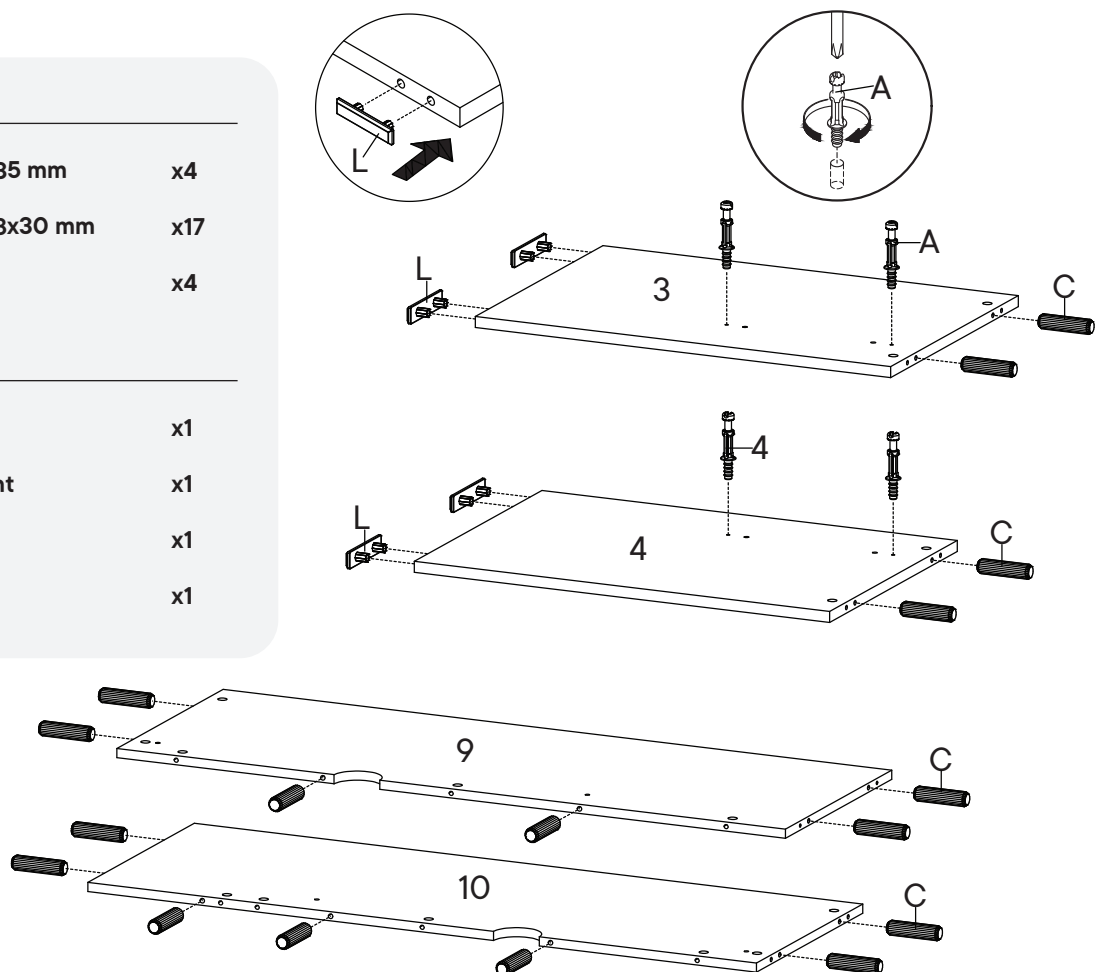

Step 5

HARDWARE

- B** Cam Lock Ø15 mm x2
- J** Screw Cap Ø15 mm x2

COMPONENTS

- 4** Side Board Right x1
- 10** Back Board 2 x1

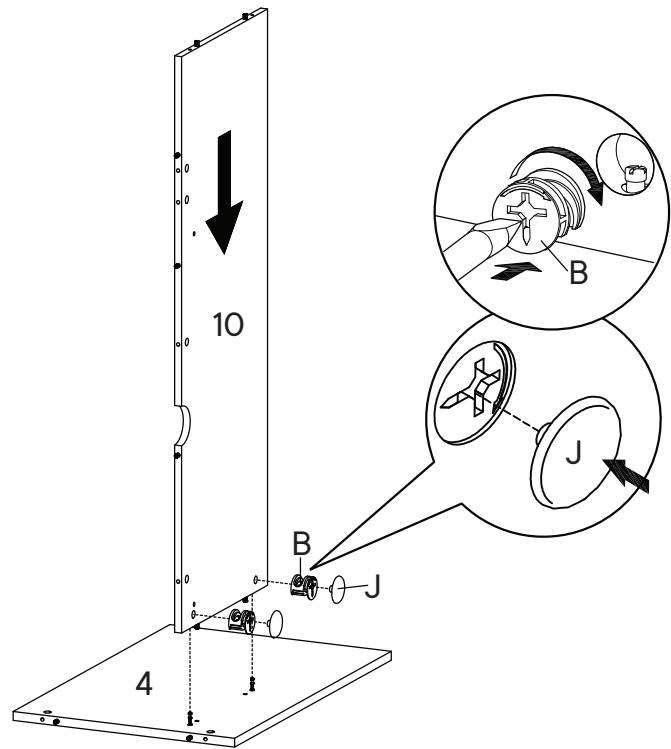

Step 6

HARDWARE

- G** Screw M 7 x 50 mm x2
- H** Allen Key x1

COMPONENTS

- 4** Side Board Right x1
- 10** Back Board 2 x1

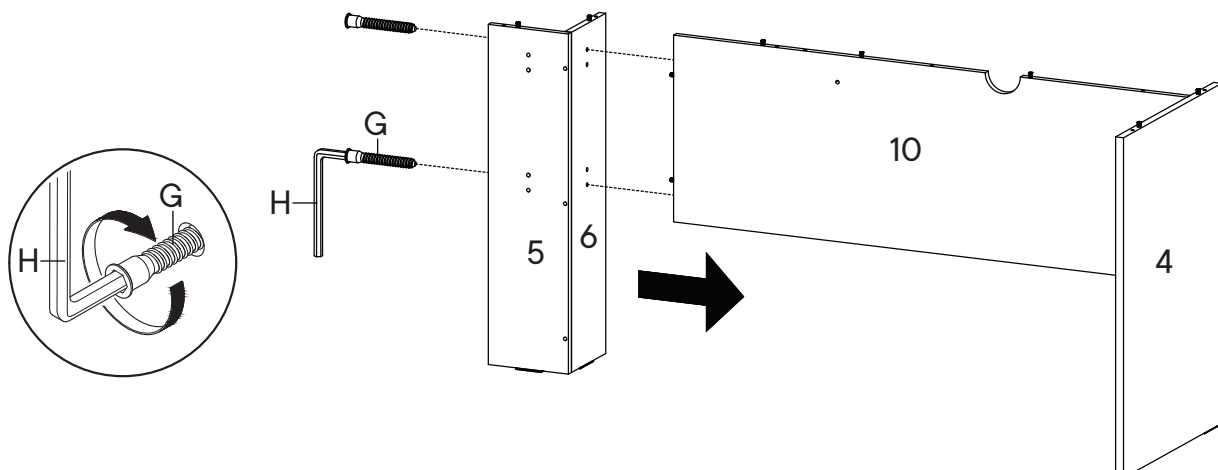

Step 7

HARDWARE

- B** Cam Lock Ø15 mm x2
- J** Screw Cap Ø15 mm x2

COMPONENTS

- 3** Side Board Left x1
- 9** Back Board 1 x1

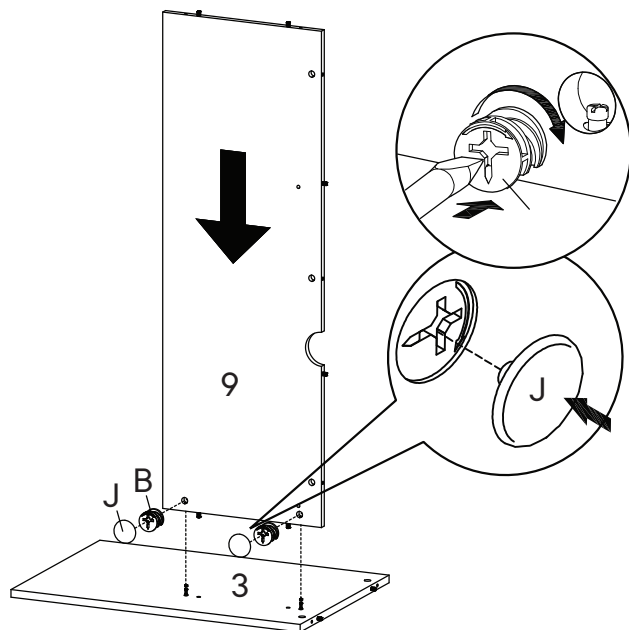

Step 8

HARDWARE

- G** Screw M 7 x 50 mm x2
- H** Allen Key x1

COMPONENTS

- 3** Side Board Left x1
- 9** Back Board 1 x1

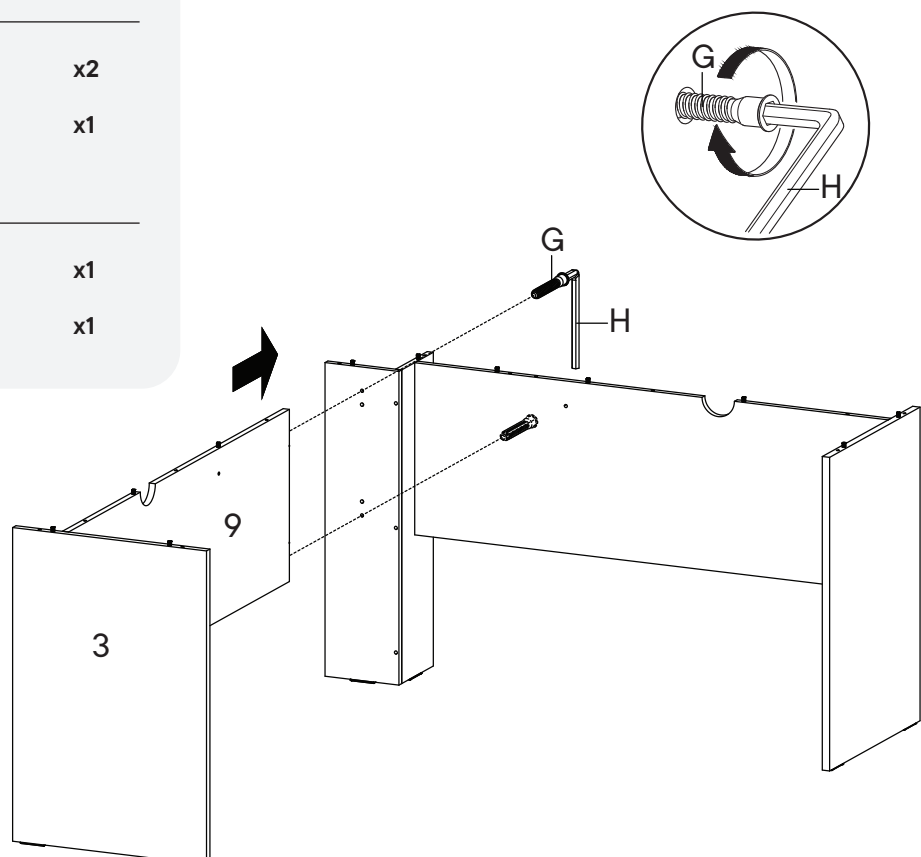

Step 9 (Option A)

HARDWARE

- A** Cam Bolt $\varnothing 6 \times 35$ mm x17
- I** Mending Plates x2
- E** Screw M 4.5 x 12.5 mm x6

COMPONENTS

- 1** Top Board 1 x1
- 2** Top Board 2 x1

DRAWER ON THE LEFT

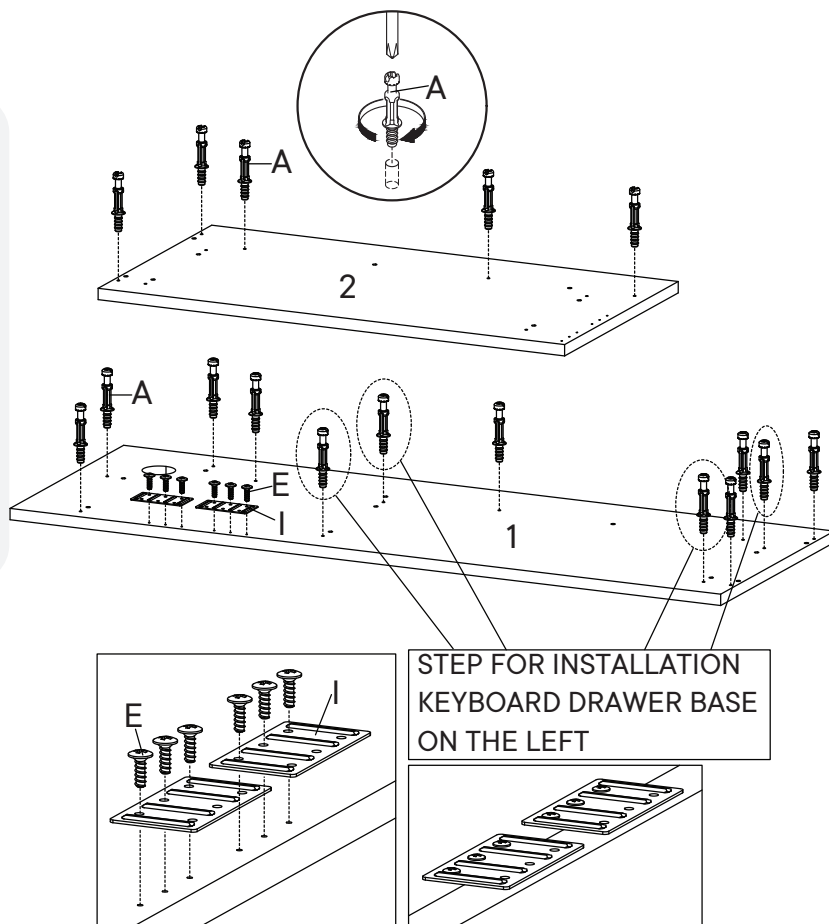
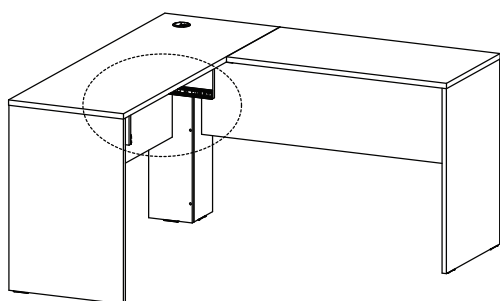

Step 9 (Option B)

HARDWARE

- A** Cam Bolt $\varnothing 6 \times 35$ mm x17
- I** Mending Plates x2
- E** Screw M 4.5 x 12.5 mm x6

COMPONENTS

- 1** Top Board 1 x1
- 2** Top Board 2 x1

DRAWER ON THE RIGHT

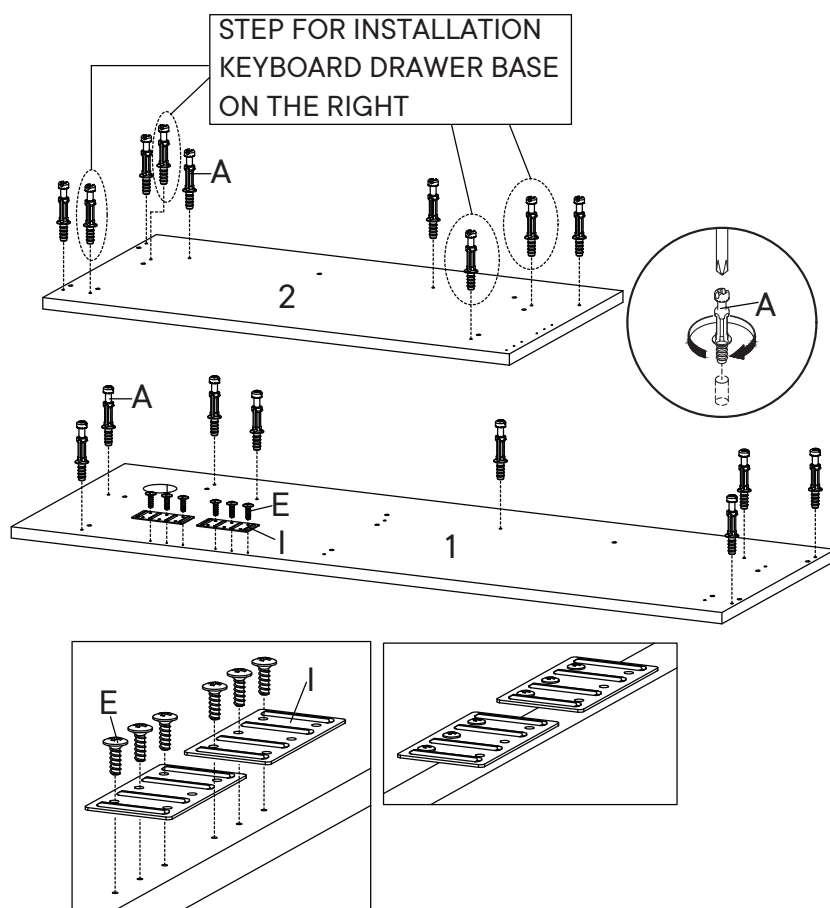
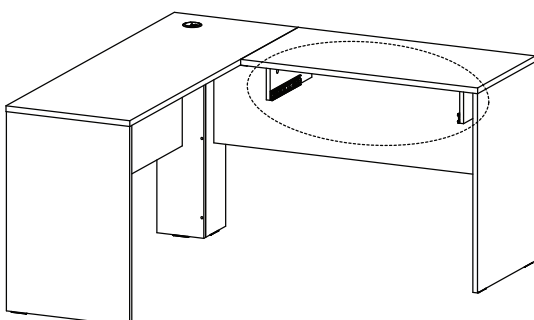

Step 10

HARDWARE

- B** Cam Lock Ø15 mm x8
- J** Screw Cap Ø15 mm x6
- K** Screw Cap Ø15 mm x2

COMPONENTS

- 1** Top Board 1 x1

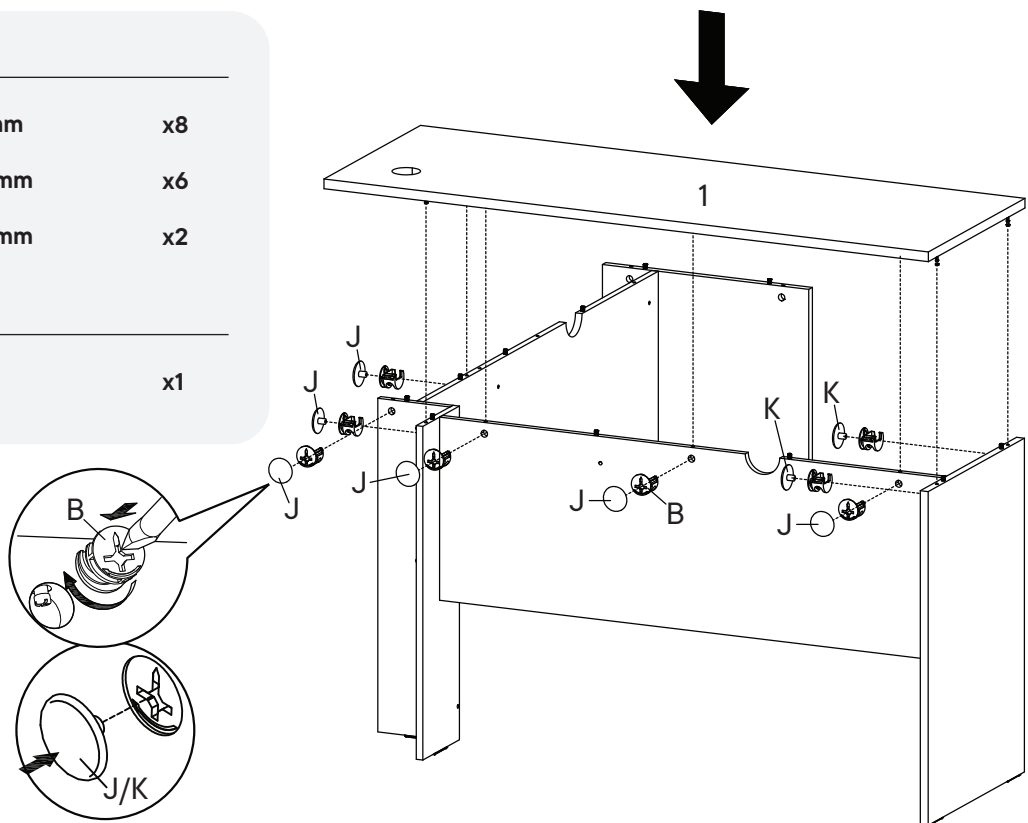

Step 11

HARDWARE

- B** Cam Lock Ø15 mm x5
- J** Screw Cap Ø15 mm x3
- K** Screw Cap Ø15 mm x2

COMPONENTS

- 2** Top Board 2 x1

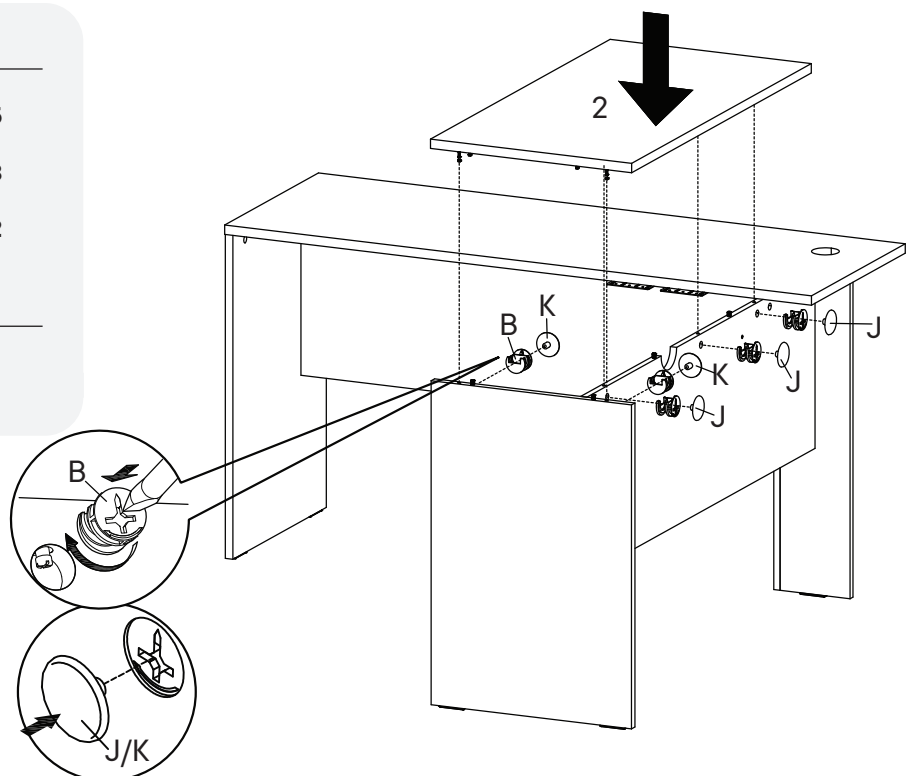

Step 12

HARDWARE

- E** Screw M 4.5 x 12.5 mm x6

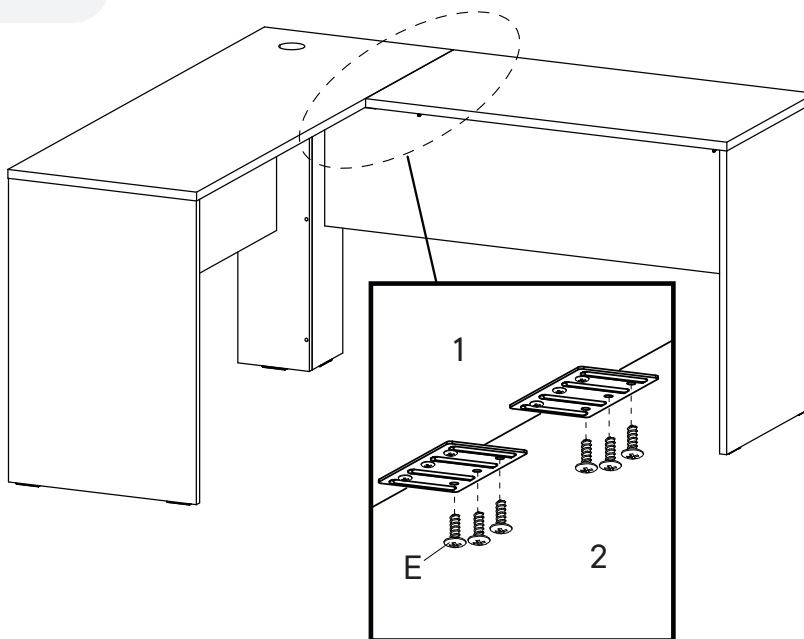

Step 13 (Option A)

HARDWARE

- B** Cam Lock Ø15 mm x4
- J** Screw Cap Ø15 mm x4

COMPONENTS

- 7** Center Board 3 x1
- 11** Center Board 4 x1

STEP FOR INSTALLATION
KEYBOARD DRAWER BASE
ON THE LEFT

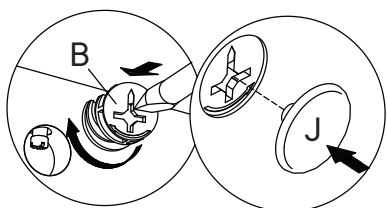
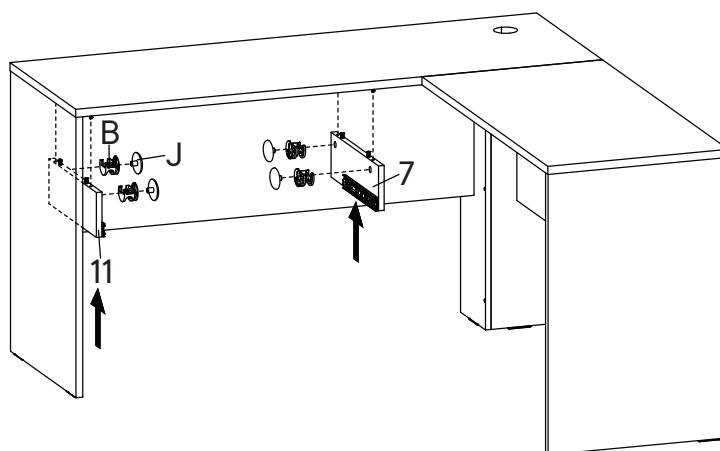

Step 13 (Option B)

HARDWARE

B Cam Lock Ø15 mm x4

J Screw Cap Ø15 mm x4

COMPONENTS

7 Center Board 3 x1

11 Center Board 4 x1

STEP FOR INSTALLATION
KEYBOARD DRAWER BASE
ON THE RIGHT

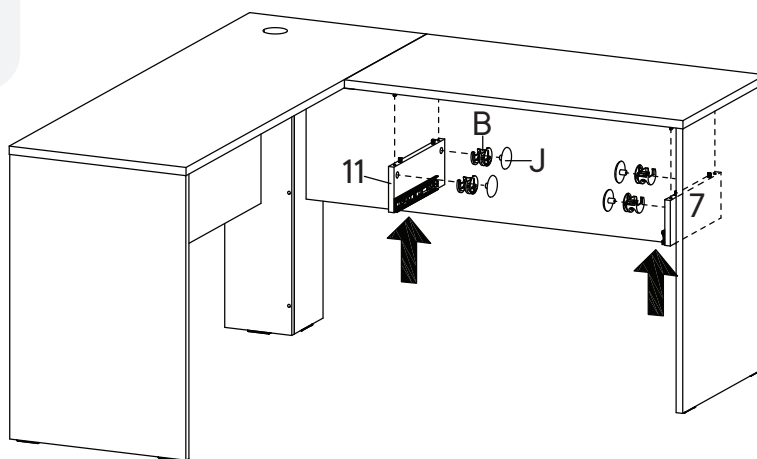
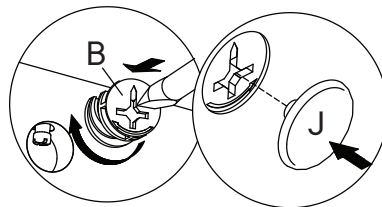

Step 14 (Option A)

HARDWARE

G Screw M 7 x 50 mm x2

H Allen Key x1

M Screw Cap Ø10 mm x4

STEP FOR INSTALLATION
KEYBOARD DRAWER BASE
ON THE LEFT

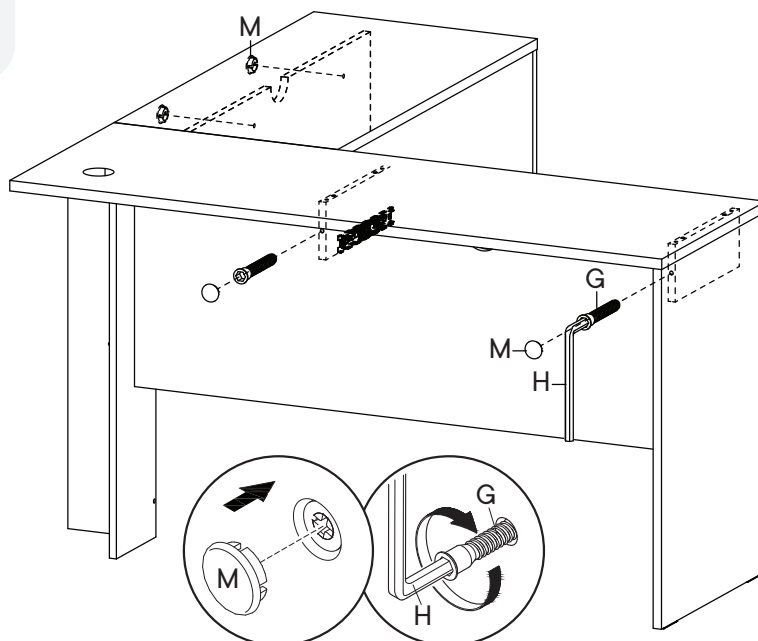

Step 14 (Option B)

HARDWARE

- G** Screw M 7 x 50 mm x2
- H** Allen Key x1
- M** Screw Cap Ø10 mm x4

STEP FOR INSTALLATION
KEYBOARD DRAWER BASE
ON THE RIGHT

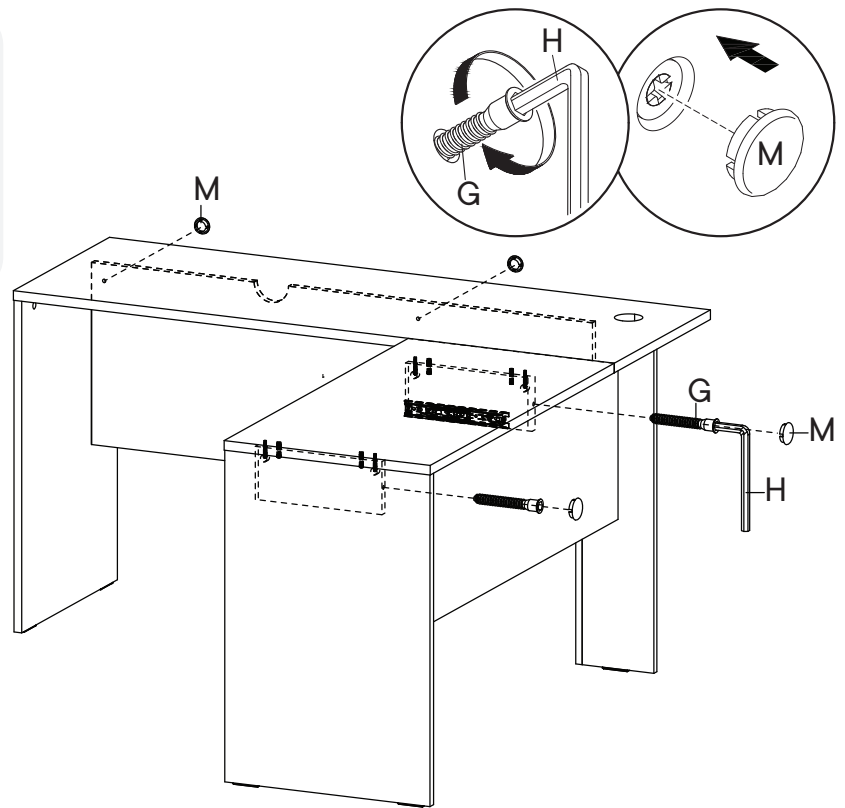

Step 15

HARDWARE

- D** Screw M 6 x 10.5 mm x4
- RB25A** Keyboard Drawer Runner x1

COMPONENTS

- 8** Keyboard Drawer Base x1

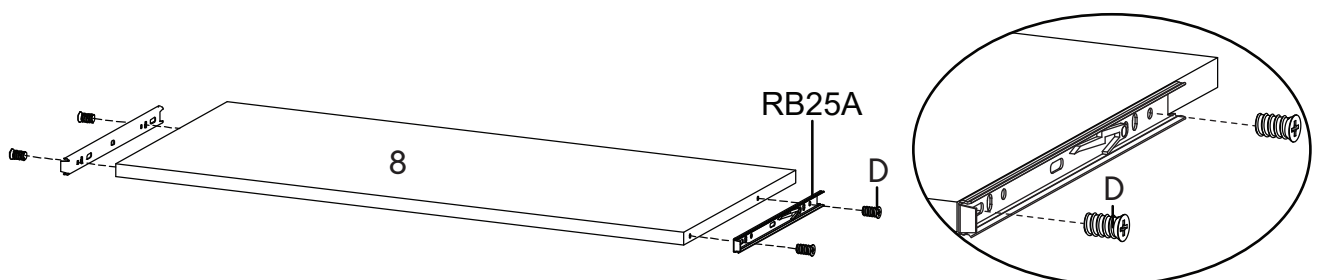
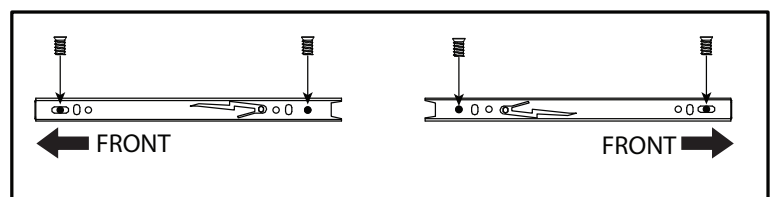

Step 16

HARDWARE

F Grommet Cover x1

COMPONENTS

8 Keyboard Drawer Base x1

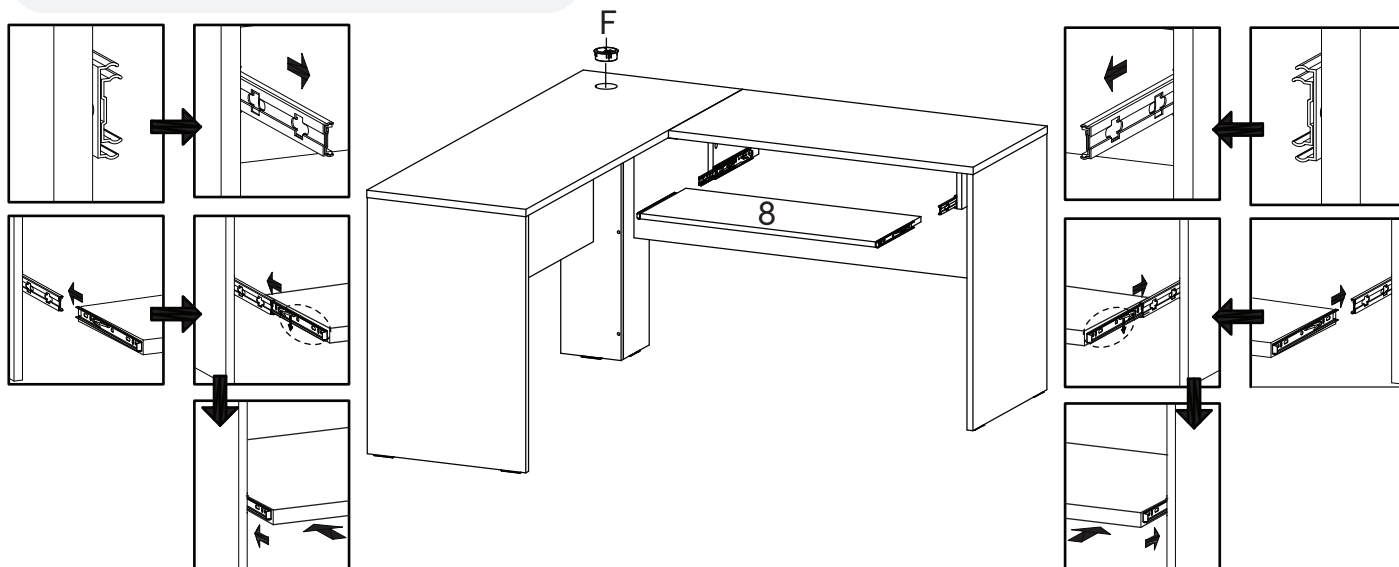

Great job!

Desk assembly is complete

♥ CARING FOR YOUR ITEM

Indoor use only.

Not contract grade.

Clean using a non-abrasive cloth and a mild cleaner.

Never use harsh chemicals, as they could damage the finish or integrity of the item.

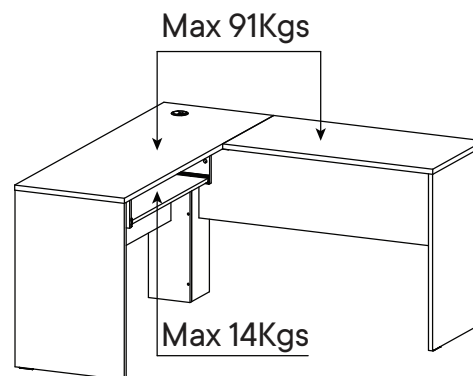
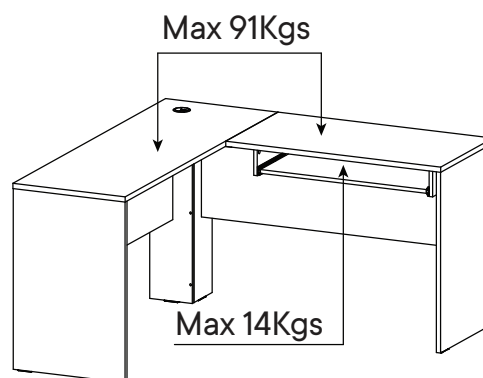

CONNECT WITH US!   

Tag us @modway_furniture and #modway for a chance to be featured.